

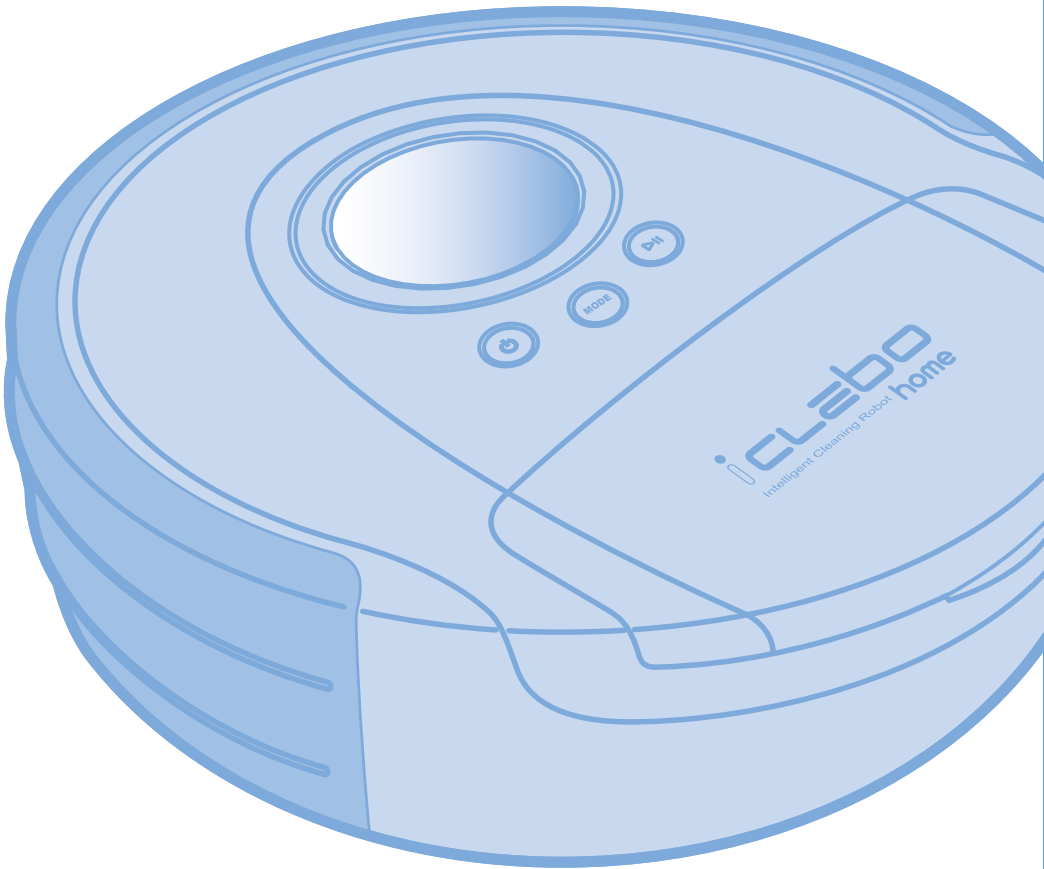

Model Name	Iclebo home
Color	Black pearl
Size	D : 35cm , H : 10cm
Weight	3.9kg
Speed	30cm /sec
Charging time	About 2 hours
Using time	Maximum 90 minutes
Battery	Lithium Ion
Noise Level	60dB
Energy consumption (Battery 4S1P)	Charging : 41.8 Watt Standby : 1 Watt under

YCR-M04-02
Robot Cleaner
User Manual



Safety Precautions	-----	2
Components and detailed names	-----	5
Reference		
	Details for best cleaning -----	6
	Operating principles of robot cleaner -----	7
	• Running of robot cleaner	
	• Suction of robot cleaner	
	• Using remote control	
Installation of robot cleaner		
	Check list before using -----	8
	• Insert battery	
	• Assemble side-brush	
	• Assemble ultra microfiber mop	
	• Remove protection film	
	• Insert remote control battery	
	Check list before cleaning -----	9
	• Install Charging station	
	• Charging	
	• Time setting	
	• Cleaning space preparation	
Usage of robot cleaner		
	Using the robot cleaner -----	11
	• Start / stop cleaning	
	• Using move, charge, turbo function	
	Cleaning mode -----	12
	• Auto-mode	
	• Spot mode	
	• Climb mode	
	• Mopping mode	
	Timer cleaning -----	12
Product control & maintenance		
	Empty dust bin -----	13
	Filter cleaning	
	Change antibacterial filter	
	Ultra microfiber mop control	
	Main brush cleaning	
	Sensor control	
	Front-wheel cleaning	
	Side-brush cleaning	
	Mend the robot cleaner	
	Mend the Charging station	
Storage	-----	17
Check before repair report	-----	18
Display error message	-----	19
Warranty	-----	20



This content is for the user's safety and to prevent any property loss.
Read the below carefully and use it with care.



Prohibition

Users must be aware of necessary details for using this product.



Warning

Users must follow the instructions to avoid serious injury or death.



Caution

Users must follow the instructions to avoid light injury or product damage.

Precautions related to power



- Do not force to bend the power cord or pressure it with heavy weight.
 - It may cause electric shock or fire.
- Keep the pin and interface of the power plug clean from dust or water.
 - It may cause malfunction or electric shock.
- Do not pull the power cord or touch the power plug with wet hands.
 - It may cause electric shock or fire.
- Do not use damaged power plug or power cord, loose outlet.
 - It may cause electric shock or fire.
- In case the water went inside the product, you must contact service center for check-up even the product was dried thoroughly.
- Do not put or pull the power plug consecutively.
 - It may cause electric shock or fire.
- In case of direct charging with adapter, connect the adapter to the charging socket of robot cleaner properly.
 - It may cause electric shock or fire.

Precautions before using



- Do not touch the power cord of the charger with wet hands.
→ It may cause electric shock.



- Arrange the cable or wire before use to avoid being wrapped with cable or wire.
→ It may cause fire or electric shock due to damaged cable.



- Remove light objects or fibers before use.
→ It may cause barrier or object damage while using.



- Remove small or fragile objects from the cleaning area before use.
→ Fragile pottery or glass product must be removed.
→ Remove coins or expensive jewelries before cleaning.



- Clean the objects on the floor.
→ Thin towel, pad, power cord, table cloth, belt placed in front of the bathroom, sink, entrance, utility room may get tangled with the wheel. Also, objects on the table or dining table may fall down.



- Empty the dust bin before operating the robot cleaner.
→ Suctioning function may not perform well if dust bin is full.



- Check the main components such as antibacterial filter, brush and dust bin are assembled properly before cleaning.
→ In case you operate the robot cleaner without the main components such as antibacterial filter or brush, it won't clean and it may cause breakdown.



- Do not operate robot cleaner when children or pets are left alone.
→ Robot cleaner may draw attention from children or pets.
It can cause injury when you get stuck on the wheel.
If the robot cleaner is distracted while cleaning, it will recognize it as a barrier and certain areas may not be cleaned.



- Do not expose the power cord on the floor when installing charging station.
→ Robot cleaner may drag the power line while auto-charge or cleaning.



- Keep the top of the charging station away from water.
→ It may cause electric shock or fire.

Precautions while using



- In case the robot cleaner has unusual sound, smell or smoke, separate the battery immediately and block the power switch then contact **your local customer center**.

→ It may cause electric shock or fire.



- Do not use the robot cleaner on the table or any place high.

→ It may damage the product.



- In case of particular hardwood floor, scratch or damage may occur while using the product according to its material. Stop using in this case.



- In case plastic bin or big foreign substance was suctioned, remove it immediately.

→ It may cause serious damage to the robot cleaner when it's used for a long period with its suction duct clogged.



- Transfer the robot cleaner to other area when it's blocked by threshold of the entrance or porch while operating.



- Prevent the robot cleaner from suctioning liquid materials.

- Do not use the robot cleaner near flammables such as cigarette, hot materials or gasoline.

→ It may cause fire.



- Do not use it for outside.

Precautions after using



- In case foreign substance is stuck on the sensor part, it may malfunction. Please clean the sensor regularly.



- In case of cleaning the foreign substance, turn OFF the power switch then use cleaning brush to remove.
→ If the robot cleaner operates all of the sudden, it may cause injury or serious damage to the product.



- In case the robot cleaner or components are destroyed, contact the manufacturer or service center for check-up.
→ It may cause electric shock or fire.



- In case of mending the charging station, pull out the power plug first for safety reasons.



- Battery is dangerous for explosion possibility. Do not dispose in to flammables or dismantle.
→ It may cause fire.



- Do not spray water directly or wipe the robot cleaner with volatile materials such as benzene, thinner or alcohol when mending the product.



- Do not force to press or pressure the bumper.

→ In case the bumper sensor is damaged, it may crash on the wall or with furniture.



- Do not disassemble, repair or convert the product except for the assigned service staff from our company.
→ It may damage the product.

Components

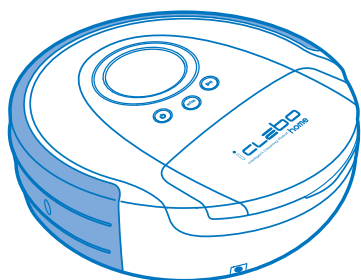

Robot cleaner

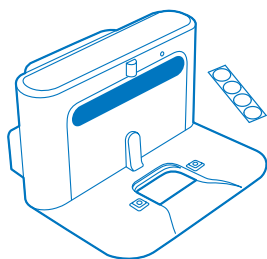

Charging station
(Spare double-sided
tape for floor fixing)

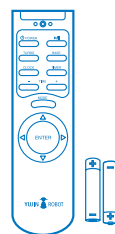

Remote control
(included battery)



User Manual

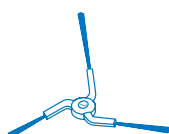

Side-brush(L)



Side-brush(R)



Antibacterial filter



Cleaning brush

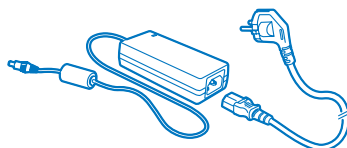

Power adapter



Battery

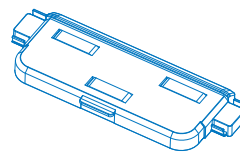

Mop plate

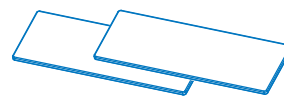

Ultra microfiber wet mop

Detailed names of each parts

● Top of the robot cleaner

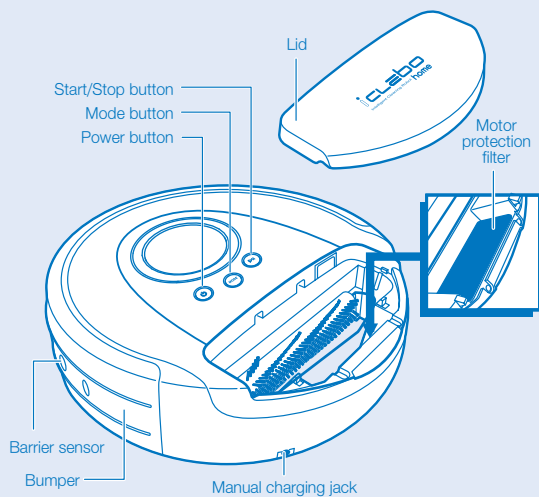

● Bottom of the robot cleaner

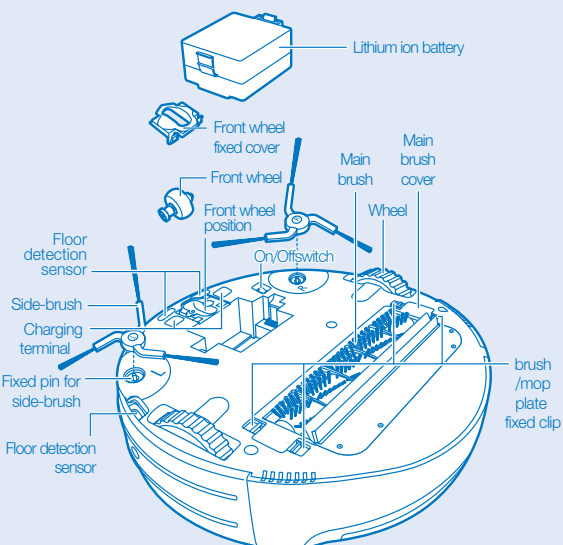

● Charging station

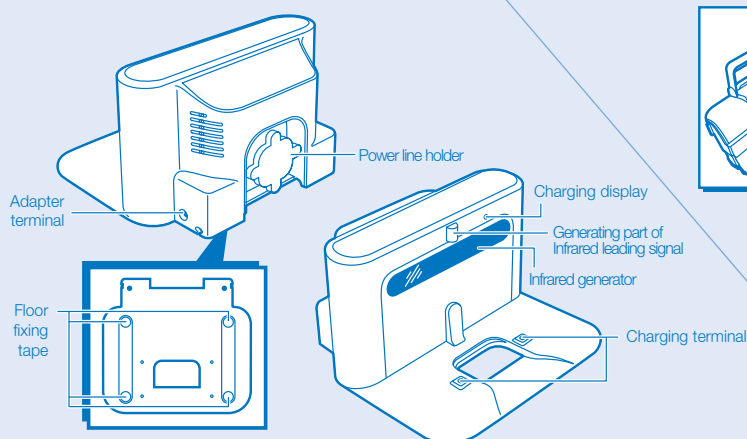

● Dust bin

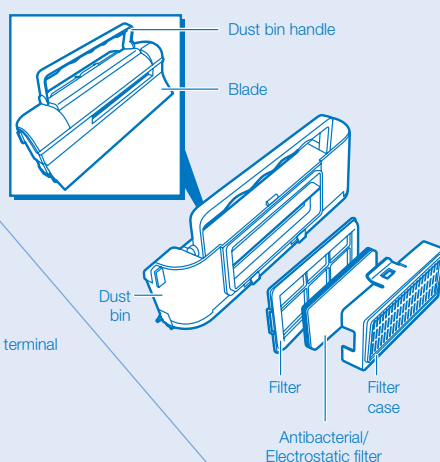

● Remote control

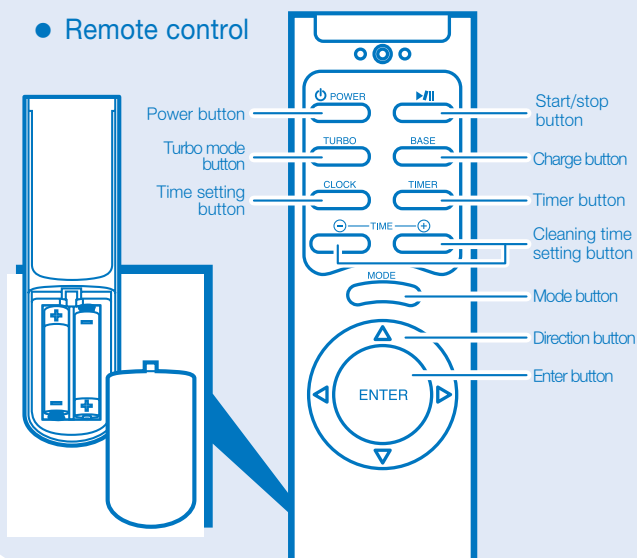

● Display screen

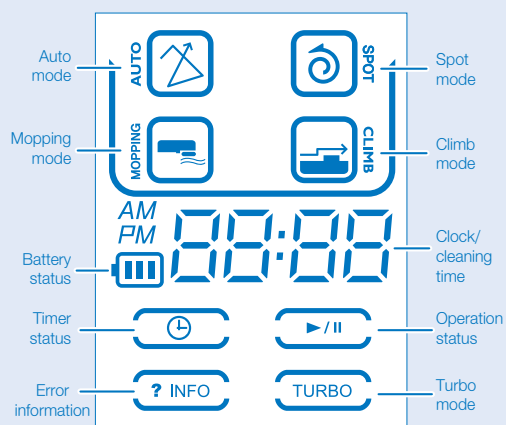

Details for best cleaning

Please follow the instructions below for high cleaning efficiency.

- Empty the dust bin after using the robot cleaner.
- Close the door to separate the areas for cleaning.
- Remove all the non-fixed objects such as toys, magazines or shoes before cleaning.
- Do not lift up or move the robot cleaner manually while operating.
Robot cleaner may lose track of the route and certain areas may not be cleaned.
- Always press the power button to start the robot cleaner and use remote control to turn off the power. Press Start/stop (►/II) button to resume cleaning from the start.

Operating principles of robot cleaner

Running of robot cleaner

With about 20 detection sensors, it can avoid wall or objects (chair, vase, etc).
It recognizes the obstacle in front of fixed object with more than 13mm high and does not fall down on the stairs with its floor detection sensor.

Suction of robot cleaner

This product has one main brush, two side-brushes and vacuum suction duct.
Side-brush gathers the dust on the floor by spinning and main brush will sweep up by rotating.
Fine dust will pile up in the dust bin through vacuum suction duct.
Empty the dust bin after use and wipe the main brush & side-brush regularly.
For further information, refer to <<Product control and maintenance>>(p.13~).

Using remote control

It is more convenient when you operate the robot cleaner with remote control.

- Press the power button of the remote control to start robot cleaner.
Press **power button** to stop the operation of the robot cleaner when it's cleaning.
- User can choose one from four modes with Mode select button.
Select **Auto-mode** for general cleaning.
For wet mop cleaning, select **Mopping mode**.
Spot mode is for cleaning the certain spot area and
Climb mode is for cleaning the area with threshold.
For further information, refer to <<Cleaning mode>>(p.12).
- The strength of suctioning will be higher by pressing **Turbo button**.
- Use **Base button** to charge.
- Use **Clock button** to set the time.
- Use **Timer button** to timer the cleaning.
- Use direction button to change the movement of the robot cleaner.
- Backward direction button of the remote control does not work.

Check list before using

Insert battery



Battery included in the box must be installed before using the robot cleaner.

1. Place a soft cloth on the floor and put the bottom of the robot cleaner facing upward.
2. Push the battery into the battery spot until you hear 'click' sound.

[Note] When you use the robot cleaner for the first time, charge the battery for three full hours before use.
(This is for the lifespan of the battery and effective use.)

Assemble side-brush

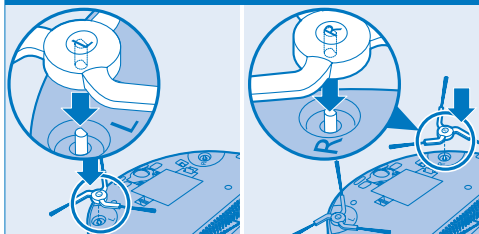

1. Take out the side-brush from the box.
2. Turn the robot cleaner over to push the L-shaped side-brush into semicircle L-shaped display.
3. Turn the robot cleaner over to push the R-shaped side-brush into semicircle R-shaped display.

Assemble ultra microfiber mop

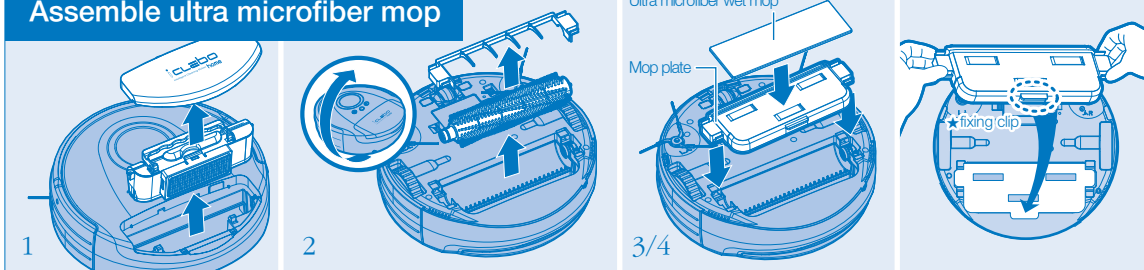

1. Open the dust bin cover of the robot cleaner to separate the dust bin.
2. Turn the robot cleaner over to separate main brush cover and side-brush.
3. Assemble the mop board to the fixing part on the bottom of the robot cleaner. **Insert the mop carrier, the fixing clip should face outwards.**
4. Squeeze the mop to moderate then attach it to the mop board.

[Note] If the mop is not assembled properly, it may be separated while cleaning. After assembling the mop board and microfiber mop, do not operate on the carpet.
- Belcro tape may cause damage on the carpet or recontamination.

※ Example of proper assembly



※ Example of wrong assembly



Remove protection film



1. Remove the protection film from the infrared signal generator and display screen of the robot cleaner.

[Note] If the protection film is not removed, it may cause problem to the performance of the robot cleaner.

Insert remote control battery



Two batteries for remote control (alkaline AAA 1.5V) are included when you purchase this product. Insert batteries before use. Use the same type of battery once its duration is over.

1. Open the battery cover of the remote control.
2. Check the (+) and (-) pole then push the batteries in.
3. Place the cover properly then push strong until you hear 'click' sound.

Check list before cleaning

Install charging station

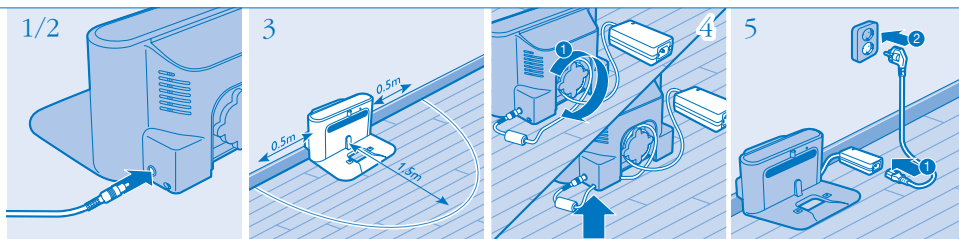

1. Connect the adapter to the charging station.
2. Make sure to place it on a flat wall and floor.
[Note] Fix the station with the sticker on the bottom for safer use.
3. No barriers should exist within left/right 0.5meters, front 1.5meters from the charging station.
4. Wind the power cord shown as ①.
5. Connect the power cord and adapter as the picture above.

Status display lamp will appear red on the charging station.

Charging

[Note] Robot cleaner can last for **maximum 90 minutes** when it's fully charged. In case the battery is not enough, it takes **about two hours** for re-charging.

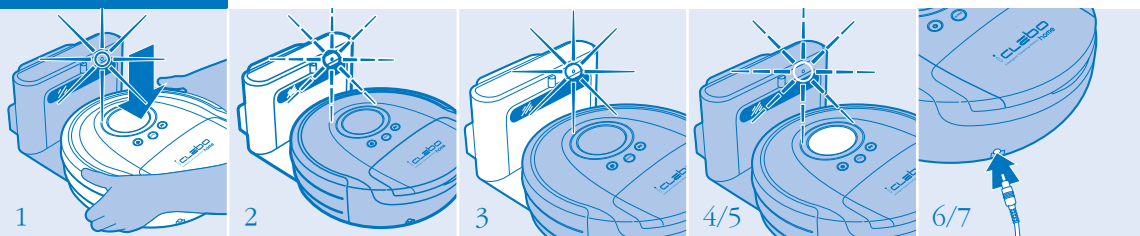

Charging with power off

1. In case the robot cleaner was not used for a long period or the power turned off due to battery shortage, stick the robot cleaner to the charging terminal of the charging station.
2. Once the robot cleaner is properly placed to the charging station, the status display lamp will flash as green.
3. Status display lamp will appear green when the charging is complete.

Auto-charge during use

- If the battery is not enough when the robot cleaner is operating, it will return to charging station for re-charge.
[Note] If you want to charge the robot cleaner while cleaning, press Base button on the remote control. Robot cleaner will move to charging station for re-charge.
- Once the robot cleaner is properly placed to the charging station, the status display lamp will flash as green. Status display lamp will appear green when the charging is complete.

Charge manually

- Connect the adapter to the main body of the robot cleaner directly.
- Connect the power cord to the adapter then put the power plug into the outlet.

Time setting

Remote control is required to set the time.

[Note] Current time must be set to use timer function.

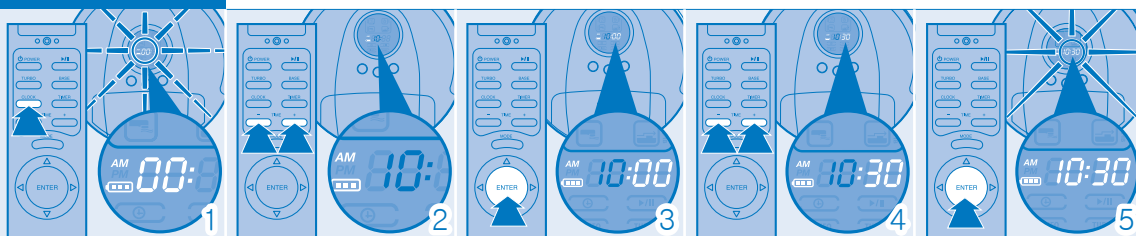

- Press the Clock button on the remote control.
Time display of the display screen will flicker.
- Set the “Hour” with TIME (+), (–) button on the remote control.
- Press Enter button to confirm the setting.
- Set the “Minute” with TIME (+), (–) button on the remote control.
- Press Enter button to confirm the setting.

Cleaning space preparation

Arranging the areas to clean enables efficient and fast cleaning.

- Remove toys, magazines and shoes from the floor.
- Close the door of unnecessary areas for cleaning.

Using the robot cleaner

Start/stop cleaning

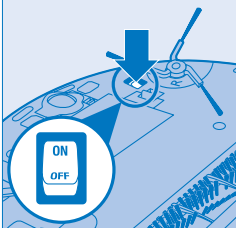

1. Turn On the power switch on the bottom of the robot cleaner.

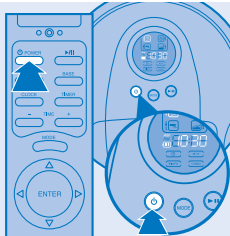

2. Press the power button of the robot cleaner or remote control. Status of the robot cleaner will be ready mode and light will appear on the display screen.

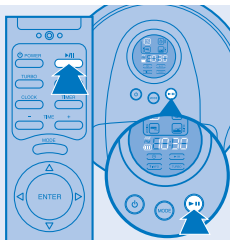

3. Press **Start/stop** (▶/||) button of the robot cleaner or remote control to start cleaning. If no mode was selected, it will start as Auto-mode automatically.

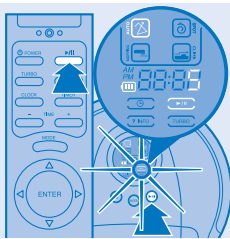

4. Press **Start/stop** (▶/||) button on the main body or remote control to stop the robot cleaner temporarily.

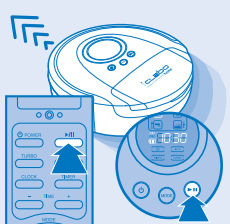

5. Press **Start/stop** (▶/||) button on the robot cleaner or remote control to resume.

Using move, charge, turbo function

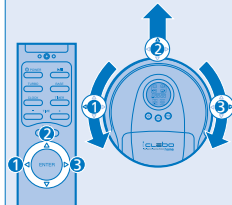

1. Use the direction button of remote control to send the robot cleaner to specific area. **[Note]** But, the backward direction button is not available. And the robot cleaner does not move backwards.

-Press Direction button to move the robot cleaner to your wanted direction. Also, user can change the direction when the power is on but not suctioning.

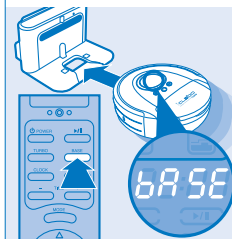



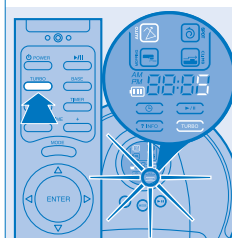

2. Press **Base** button of the remote control to make the robot cleaner return to the charging station.

(Base) message will appear on the display screen then robot cleaner will move to the charging station and start charging.



3. Press **Turbo** button of the remote control to operate the robot cleaner with more strength. **Turbo** display will appear on the display screen and start cleaning.

-To return to normal suction status, press **Turbo** button again.

Cleaning mode	User can set the cleaning mode with Mode button on the main body or remote control. (But, cleaning mode can be changed when the robot cleaner is stopped)	
	Auto mode	As a normal cleaning mode, it moves in zig-zag, random, along the edge of area to clean. - In case the battery is short during cleaning, it will charge first then return to its charging station. - It is set not to go over the carpet or barriers with more than 5mm. ※ If you want the robot cleaner to climb over around 5mm high barriers, change the mode to CLIMB .
	Spot mode	Spiral spot cleaning mode, it moves in spiral around within 1.5m radius. But once it can not keep moving in spiral, return to auto mode.
	Climb mode	It can climb around 13mm high threshold and cleans. The cleaning patten of the robot cleaner is the same with AUTO MODE .
	Mopping mode	Install microfiber wet mop then start mopping mode. - Dust bin and main brush must be separated from the main body to install wet mop before use. (Refer to page 8) - It is set not to go over the carpet or barriers with more than 5mm.

Timer cleaning

Timer setting

Robot cleaner will operate automatically on the set time even the user is out. **[Note]** Current time must be set to use timer cleaning.

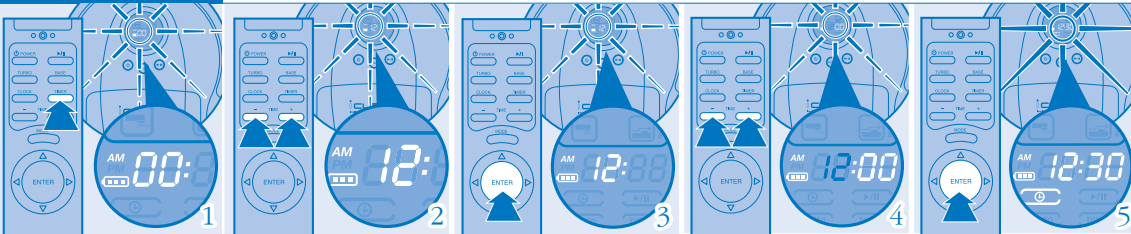

- Press **Timer** button of the remote control.
Time display will flash on the display screen.
[Note] If the time was set already, it will show the previous setting.
Press the button again to set the timer.
- Set the “**Hour**” with **TIME** (+), (-) button to desired time.
- Press **Enter** button to confirm. Display screen will show the set time.
- Set the “**Minute**” with **TIME** (+), (-) button. Display screen will show the set minute.
- Press **Enter** button after setting the desired time.
Display screen will show the timer time and the timer icon(⌚) will appear.
Robot cleaner will start cleaning on the set time.
- To cancel the timer, press **Timer** button then press **Enter** button when the time display flickers on the display screen.

※Refer to page 10 for setting the current time.

Empty dust bin

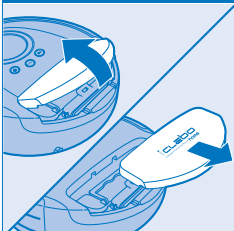
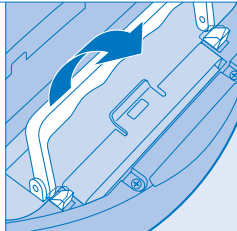
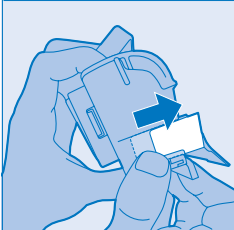
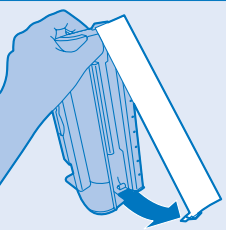
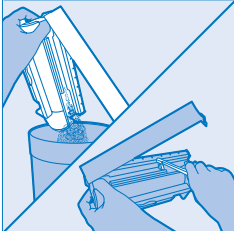
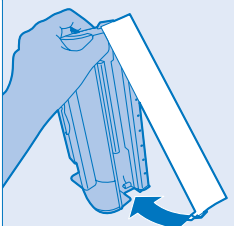
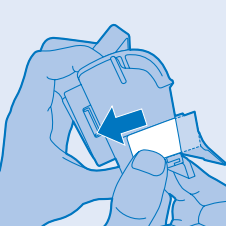
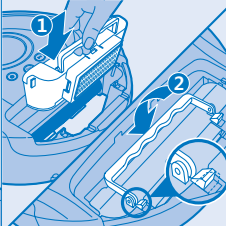
	1. Lift up the dust bin cover to separate from the main body.		2. Hold the dust bin holder and lift up then separate it from the main body.
		3. Open the dust bin fix clip as shown in the picture then divide the blade from the dust bin.	
	4. Shake the dust bin left/right to remove the waste inside. Clean the inner part of the dust bin using cleaning brush.		
			5. Close the blade then insert it to the main body.

Filter cleaning

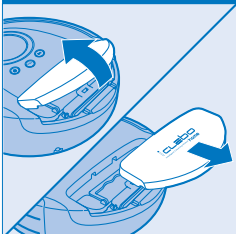
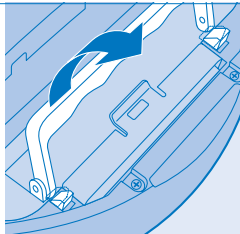
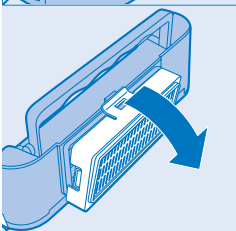
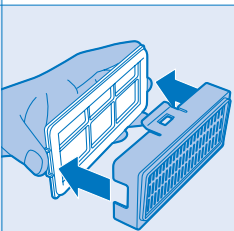
	1. Lift up the dust bin cover to separate from the main body.		2. Hold the dust bin holder and lift up then separate it from the main body.
		3. Divide the filtering device from dust bin as shown in the picture then separate the filter.	

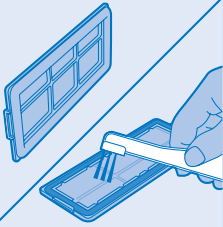
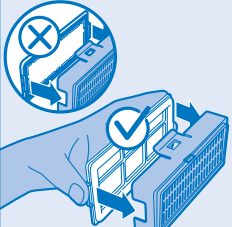
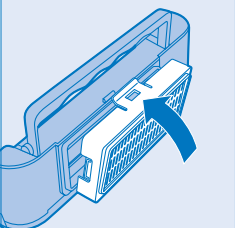
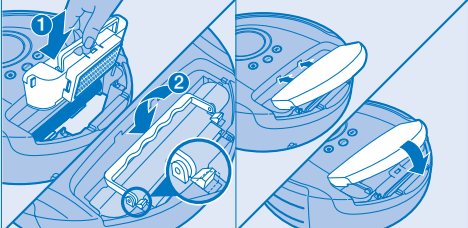
	<p>4. Clean the filter using the cleaning brush.</p>		<p>5. After cleaning, align the black rubber border side to the filtering device then assemble.</p>
		<p>6. Attach the filtering device to the dust bin then insert it to the main body.</p>	

Change antibacterial filter

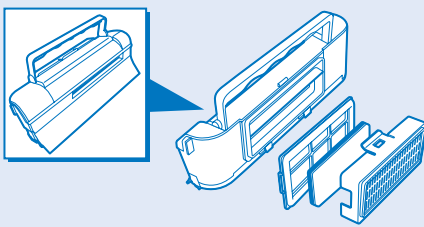
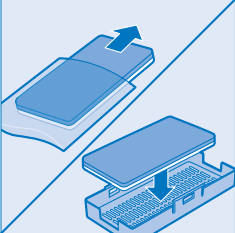
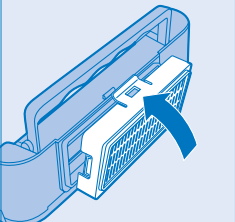
	<p>1. Separate the dust bin from the main body then divide the filter of the dust bin.</p>		
	<p>2. Change the used antibacterial filter to new one after dividing the filter. ※ The white side of the antibacterial filter to the filter case then assemble.</p>		
	<p>3. Insert the dust bin with new antibacterial filter to the main body.</p>		

Ultra microfiber mop control

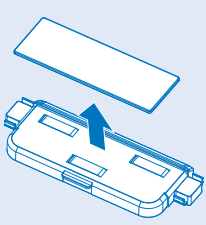
	<p>1. Separate the microfiber mop from the mop board. 2. Dry it thoroughly after cleaning. (※ Refer to page 8 for assembly.)</p>		
---	--	--	--

Main brush cleaning

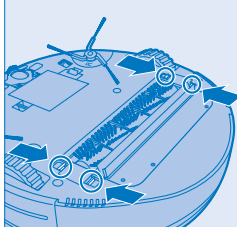
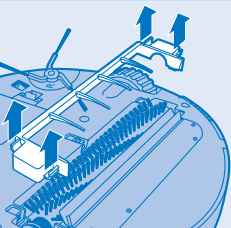
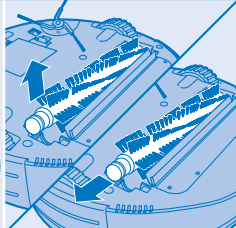
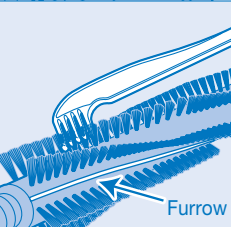
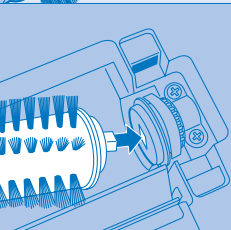
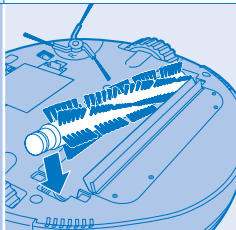
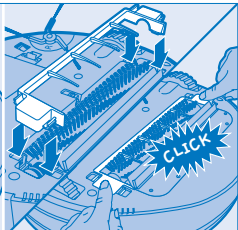
	<p>1. Turn the robot cleaner over and place the bottom facing upside.</p>		<p>2. Unlock left/right fixed clip of the main brush.</p>
		<p>3. Separate the brush cover then divide the main brush.</p>	
	<p>4. Clean the hair or foreign substance stuck on the main brush using the cleaning brush.</p> <p>※Use scissors or knife along the main brush to remove the hair easily.</p>		
			<p>5. After cleaning, put the square-shaped bump on the left side of the main brush to the square-shaped part.</p>

Sensor control

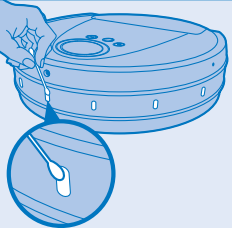
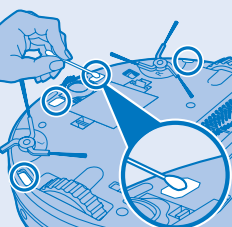
	<p>1. Wipe the sensor of the robot cleaner using cotton buds.</p>
	<p>2. Wipe the sensor on the bottom of the robot cleaner using cotton buds.</p>

Front-wheel cleaning

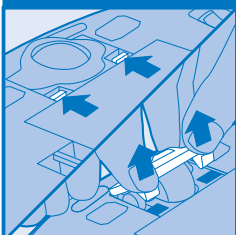

1. Press the front-wheel fix clip with both hands and lift up to separate.
2. Remove foreign substance on the wheel using the cleaning brush.

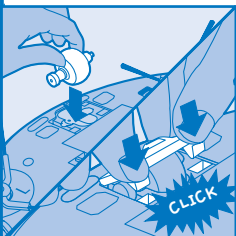
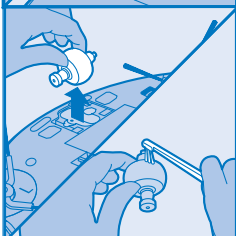

3. Pull out the front-wheel then clean dust and foreign substance using the cleaning brush.
4. Put the front-wheel back and re-assemble as the method above.

Side-brush cleaning

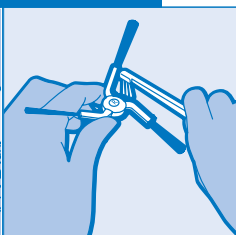
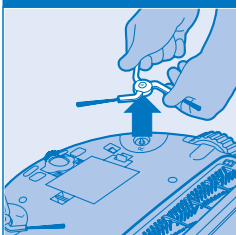

1. Separate the side-brush with both hands.
2. Clean dust and foreign substance using the cleaning brush.

Mend the robot cleaner

1. Wipe the robot cleaner with lightly wet mop.

Do not use polishing product or acetone.

Power must be turned off before mending the robot cleaner.

If the robot cleaner operates all of the sudden, it may cause injury.

Mend the home station

1. Pull out the power cord from the outlet.
2. Wipe the charging station lightly with soft cloth.

Storage

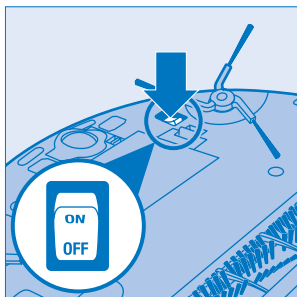

1. In case the robot cleaner is not used for a long period, turn off the power switch on the bottom of the main body.

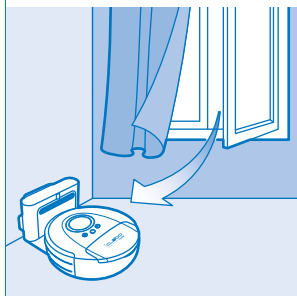

2. Keep the robot cleaner away from direct sunlight and well-ventilated place.

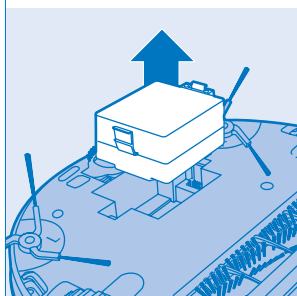

3. Separate the batteries from the robot cleaner in case not using the product for a month.



Below is the explanation about the most occurred 'breakdowns' when using this product.
If you can't solve the problem with information below, inquire to your local **Customer service center**.

Problem	Cause	Solution
It is not cleaning well.	<ul style="list-style-type: none"> ▶ Dust bin is full. ▶ Main brush is dirty. ▶ Filter is contaminated. 	<ul style="list-style-type: none"> ▶ See ⟨Product control & maintenance⟩ and empty the dust bin. ▶ See ⟨Product control & maintenance⟩ and use main brush. ▶ See ⟨Product control & maintenance⟩ and clean the dirty filter.
When I press the power button to turn on the robot cleaner, it turns off automatically.	<ul style="list-style-type: none"> ▶ Battery is low. ▶ Battery is enough but the dust bin is full. ▶ Main brush is clogged with hair and dust. 	<ul style="list-style-type: none"> ▶ Charge the robot cleaner. ▶ See ⟨Product control & maintenance⟩ and empty the dust bin. ▶ See ⟨Product control & maintenance⟩ and clean main brush.
The robot cleaner is not responding.	<ul style="list-style-type: none"> ▶ Power switch is turned off. ▶ Battery is low. ▶ Battery is not inserted properly to the robot cleaner. ▶ Battery of remote control is out. ▶ Infrared sensor & beam part of the remote control is blocked or dirty. ▶ Remote control is too near to the charging station. 	<ul style="list-style-type: none"> ▶ Check the power switch on the bottom of the main body. ▶ Re-charge the robot cleaner. ▶ Insert the battery of robot cleaner properly. ▶ Change the battery of the remote control. ▶ Wipe the infrared sensor & beam part of the remote control with soft cloth. ▶ Keep a distance from the charging station and press the button again towards the robot cleaner.
The robot cleaner is not charging.	<ul style="list-style-type: none"> ▶ Charging station or robot cleaner is not connected properly to the plug. 	<ul style="list-style-type: none"> ▶ Connect the power of charging station & robot cleaner properly.
After cleaning, the robot cleaner is not returning to the charging station.	<ul style="list-style-type: none"> ▶ Power of the charging station is not connected properly. ▶ Infrared generator & ejector on the Charging station and detector of the robot cleaner is dirty. 	<ul style="list-style-type: none"> ▶ Connect the power of the charging station properly. ▶ Move the charging station. No objects must be placed within left/right 50centimeters, front 1,5meters from the Charging station. This is to enable the robot cleaner to return to the charging station automatically after cleaning.

Noise of the robot cleaner is getting worse.	<p>▶ Dust bin is full or filter is dirty.</p> <p>▶ Main brush is dirty.</p>	<p>▶ Empty and clean the dust bin.</p> <p>▶ See <Product control & maintenance> (page 13) and clean the filter.</p> <p>▶ See <Product control & maintenance> (page 15) and clean the main brush.</p>
--	---	--

Display error message

※ In case Error info appears () on the display screen, refer to the below and solve the problem.

Error display	Cause	Solution
E 0	Low battery	Charge the robot cleaner.
E 1	Lifted wheel	Move the robot cleaner to flat area in case the wheel is stuck on the threshold or porch.
E 2	Cannot detect floor	Move the robot cleaner to flat area.
E 3	Dust bin error	Dust bin is not properly assembled. See <Product control & maintenance> and install properly.
E 4	Wheel motor overload	Check if foreign substance such as hair or lint exists on the wheel. See <Product control & maintenance> and remove the foreign substance.
E 5	Brush motor overload	Check if foreign substance such as hair or lint exists on the main brush or side-brush. See <Product control & maintenance> and remove the foreign substance.
E 6	Suction motor overload	See <Product control & maintenance> and clean filter, empty the dust bin.
E 7	Internal system error	Turn off the power switch of the robot cleaner then turn it on again.
E 8	Dust stuck on the front-wheel	Remove the front-wheel for cleaning then see <Product control & maintenance> to put it back.
E 9	Mopping mode dust bin install error	In case of selecting Mopping mode, separate the dust bin.



Product name	Robot cleaner iclbo home	Model name	YCR-M04-02
Color		Product number	
Customer name		Phone number	
Address			
Date of purchase	Place of purchase		
1 year warranty (6 months for battery)			

Customer compensation

Category	Type of consumer damage	Compensation details	
		Within warranty (1 year)	After warranty expires
Naturally caused damage on performance / functional ability under normal condition (within the possession period of the parts)	Major repair required for the main parts of the product within 1 month from the date of purchase	Exchange or free repair	
	In case defect was found	Free repair	Paid repair
	Loss occurred during delivery or installation upon the purchase of the product	Exchange product	
	Same problem occurred for the 4th time or breakdown for the 5th time with different defects	Exchange product or refund	Paid repair
	Major repair required within 10 days from the date of purchase	Exchange product or refund	
Damage on performance/ functional ability due to the customer's fault	In case the product is repairable	Paid repair	
	In case the product is irreparable	Collect the equivalent amount of paid repair service then exchange product	
-In case the product was damaged due to natural disaster (fire, sea wind, earthquake, storm and flood, etc) -In case the product was damaged by using the wrong power or faulty connection device -In case the product was damaged by the staff not assigned by our company or service center repaired or converted the product. -Other external causes except the faulty of the product itself		Paid repair	

※ Warranty of this product is for 1 year and the battery is for 6 months.