

Operating Instructions.

Mode d'emploi.
Instrucciones de manejo.



- Tremo

Sound.



233-31673.002

LOEWE.

Contents

Contenu

Índice

Tremo amplifier	3	Amplificateur Tremo	21	Amplificador Tremo	39
About this speaker system	4	A propos du système	22	Acerca de este sistema de altavoces	40
Scope of delivery		Contenu de la livraison		Volumen de suministro	
Available accessories		Accessoires disponibles		Accesorios disponibles	
Installing the subwoofer and satellite speakers	5	Mise en place du Subwoofer et des haut-parleurs satellites	23	Colocación del Subwoofer y de los altavoces satélites	41
Connection	6 – 14	Raccordement	24 – 32	Conexión	42 – 50
to the Loewe TV set with Dolby Digital		au téléviseur Loewe équipé du		con el televisor Loewe con módulo Dolby	
Module	6	module Dolby Digital	24	Digital	42
to Articos 55	7	à Articos 55	25	con Articos 55	43
to the Master Unit with Spheros 42 HD/37	8	à la Masterunit pour Spheros 42 HD/37	26	con la Master Unit en Spheros 42 HD/37	44
to the signal box	9	à la Signalbox	27	con la caja de señales	45
to Loewe Auro 8116 DT	10 – 11	à l'unité Auro 8116 DT de Loewe	28 – 29	con el Auro 8116 DT de Loewe	46 – 47
to Loewe Certos	12 – 13	à l'unité Certos de Loewe	30 – 31	con el Certos de Loewe	48 – 49
Connecting the satellite speakers to the subwoofer	14	Raccordement des haut-parleurs satellites		conexión de los altavoces satélites al Subwoofer	
Mounting the satellite speaker on the S stand	15	au Subwoofer	32		50
Start-up and operation	16	Montage des haut-parleurs satellites sur le support S-Stand	33	Montaje de los altavoces satélites en el S-Stand	51
Selecting the center signal		Mise en service et utilisation	34	Puesta en marcha y manejo	52
Switching the subwoofer on/off		Sélection du signal central		Selección de la señal central	
Settings on the TV set		Mise en marche / Arrêt du Subwoofer		Conexión/desconexión del Subwoofer	
Sound via ...		Réglages à effectuer sur le téléviseur		Ajustes en el televisor	
Setting listener/speaker distances and adjusting speaker volumes		Sortie du son par ...		Sonido por ...	
Sound reproduction via Loewe TV with connected Tremo speaker system		Réglage de la distance position d'écoute/haut-parleurs et du niveau sonore des haut-parleurs		Distancias oyente/altavoz y nivelación de los altavoces	
Phase switch/bass intensity		Restitution sonore par le téléviseur Loewe avec système de haut-parleurs Tremo		Reproducción de sonido a través del televisor Loewe con el sistema de altavoces Tremo conectado	
Technical data	17	Inverseur de phase/Intensité des basses		Conmutador de fase/Intensidad de graves	
		Caractéristiques techniques	35	Datos técnicos	53

Tremo amplifier

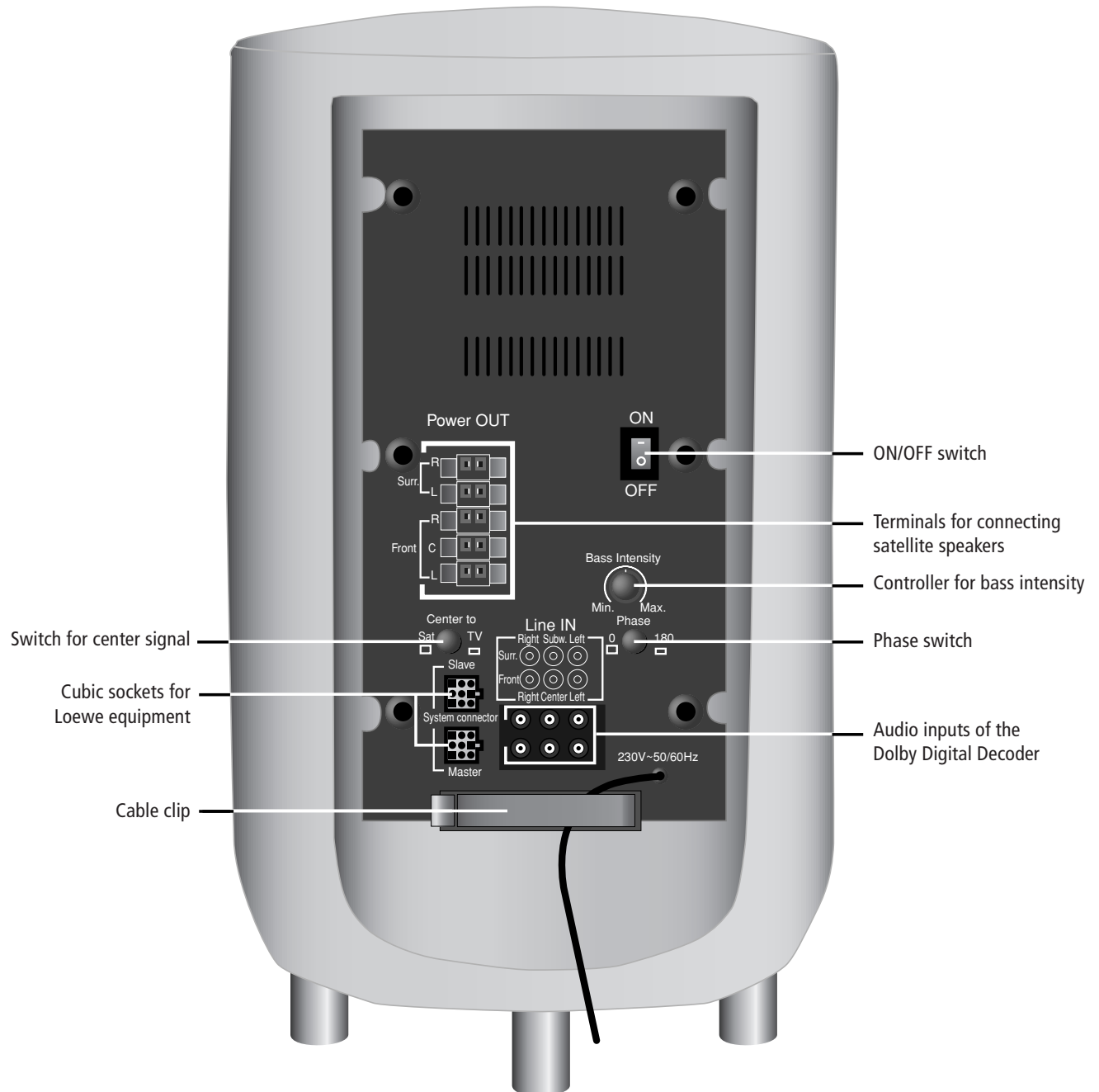

About this speaker system

Congratulations on your purchase of this Loewe product. The Tremo speaker system consists of a subwoofer with amplifier unit and five satellite speakers, all of the finest quality.

The natural material ceramic forms the basis for the subwoofer housing. It is made into the Tremo housing by a complex, multi-stage production process and skilled craftsmanship. Every piece is an exclusive original with an individual touch.

The Tremo speaker system is designed for Loewe TV sets with a Dolby Digital Decoder and connection of the Loewe DVD Preceiver Auro 8116 DT or the Certos system.

You can then play DVDs in Dolby Digital cinema quality. You can also convert stereo broadcasts or playbacks (from a video recorder or DVD player) in Dolby ProLogic, Virtualize or Circle Surround into a 5.1 surround signal and play it over the Tremo speaker system. If your TV is equipped with a digital tuner (DVB) and Certos or Auro 8116 DT are connected, the received digital Surround signal is decoded and played over the Tremo system.

On the Tremo subwoofer you can set whether the speakers of the Loewe TV set (from MediaPlus Q2500) are to transmit the center signal or whether the satellite speaker provided is to be used for this.

In sets with signal box and in Articos 55 the center signal is always played over the TV speakers.

The Tremo speaker system switches on and off automatically with the Loewe TV set, the Loewe DVD Preceiver or the Certos system.

You can make the settings for Dolby Digital comfortably using the Loewe TV menus or when using Certos or the DVD Preceiver Auro 8116 DT with their menus..

Of course you can also operate this speaker system on an external decoder, then it is not possible to use the TV's speakers as center speakers and the Tremo speaker system has to be switched on and off manually.

Scope of delivery

- 1 subwoofer
- 5 satellite speakers with conical base for stand
- 1 6-wire connecting cable (6 m) for the output signals of the Dolby Digital Decoder or the Loewe DVD Preceiver to the subwoofer.
- 1 connecting cable with cubic plugs (6 m) to the cubic socket of the Loewe TV set (from chassis MediaPlus Q2500).
- 5 speaker cables from the subwoofer to the satellite speakers in different lengths (3 x 5 m, 2 x 1.5 m).
- ... and this operating manual

Available accessories

Tremo platinum wall holder order no. 63299A00

Tremo cream wall holder order no. 63299K00

S stand (can also be used for Tremo satellite speakers)

Order no. 61250B00

Connecting cable to Certos system

Order no. 88947.001

Installing the subwoofer and satellite speakers

The satellite speakers should all be positioned at ear height, i.e. about 1 meter above the floor.

Use the available stands or wall holders or place the speakers at the appropriate height on pieces of furniture or on shelves.

The speakers and the TV set can be arranged as illustrated below.

The front and surround speakers should be placed symmetrically with the TV set and the place where you are sitting.

You can position the subwoofer anywhere on the floor. We recommend you to place it in one of the front corners of the room so that the bass signals radiate freely.

When making the settings for initial start-up, enter the distances of the center speaker, front and surround speakers from where you are sitting.

Delay times of the speakers in relation to each other are calculated and set by the Dolby Digital Module. You also adapt the volume of every speaker in the settings for initial start-up.

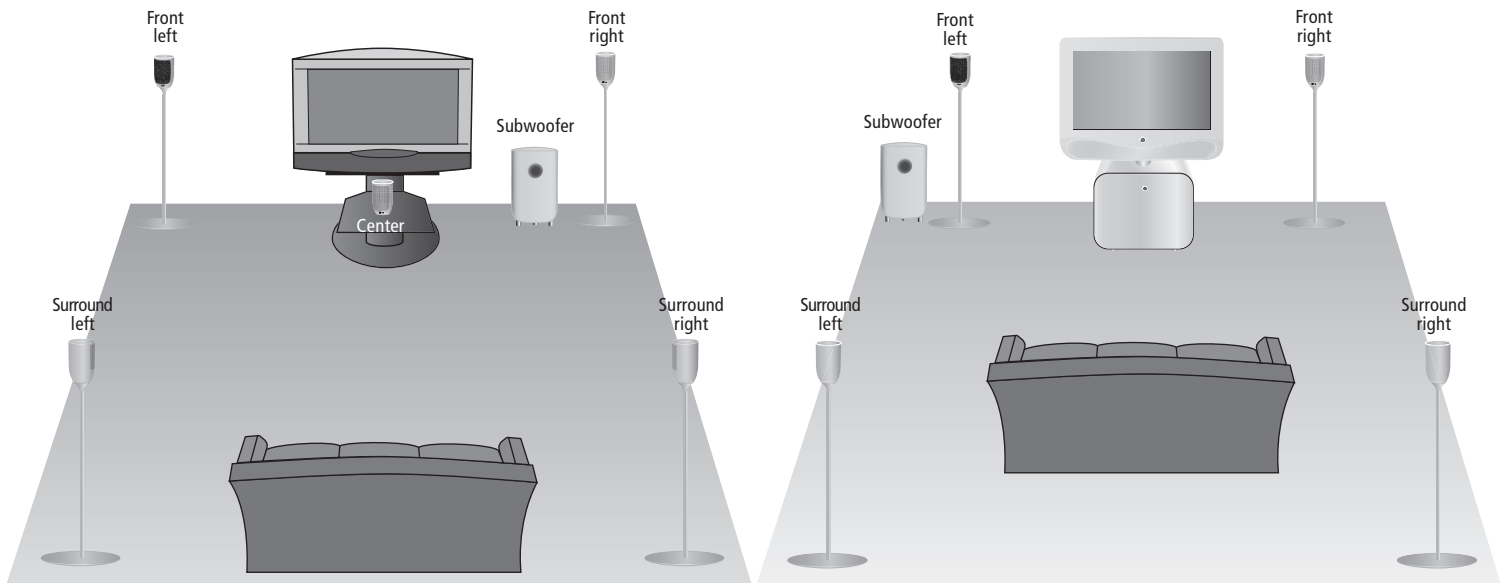

Connection

... to the Loewe TV set with Dolby Digital Module (MediaPlus Q2500, Q2550)

Pull off the subwoofer cover to the back. Open the cable clip. You will use this later to bundle the cables.

Connect the outputs of the Dolby Digital Decoder on the TV set with the audio inputs on the subwoofer. Use the ribbon cable with the six cinch plugs. The red and white plugs are additionally labelled with F for front and S for surround. Use the white plug for the left audio channel and the red plug for the right audio channel. Use the black plug for the subwoofer signal and the grey plug for the center signal.

Connect the cubic sockets of both devices to each other. Use the cable with the two cubic plugs. Plug the white cubic plug in the "Master" cubic socket on the subwoofer. There is no kink protection fitted to this plug. Plug the black plug into the cubic socket on the TV set. Pull out the bridge plug first if one exists. Lay all cables in the subwoofer downwards to be able to bundle them with the cable clip later. First lay the ribbon cable upwards and then downwards with a loop. How to connect the satellite speakers is described on page 14. The settings on the TV and on the subwoofer are described on page 16.

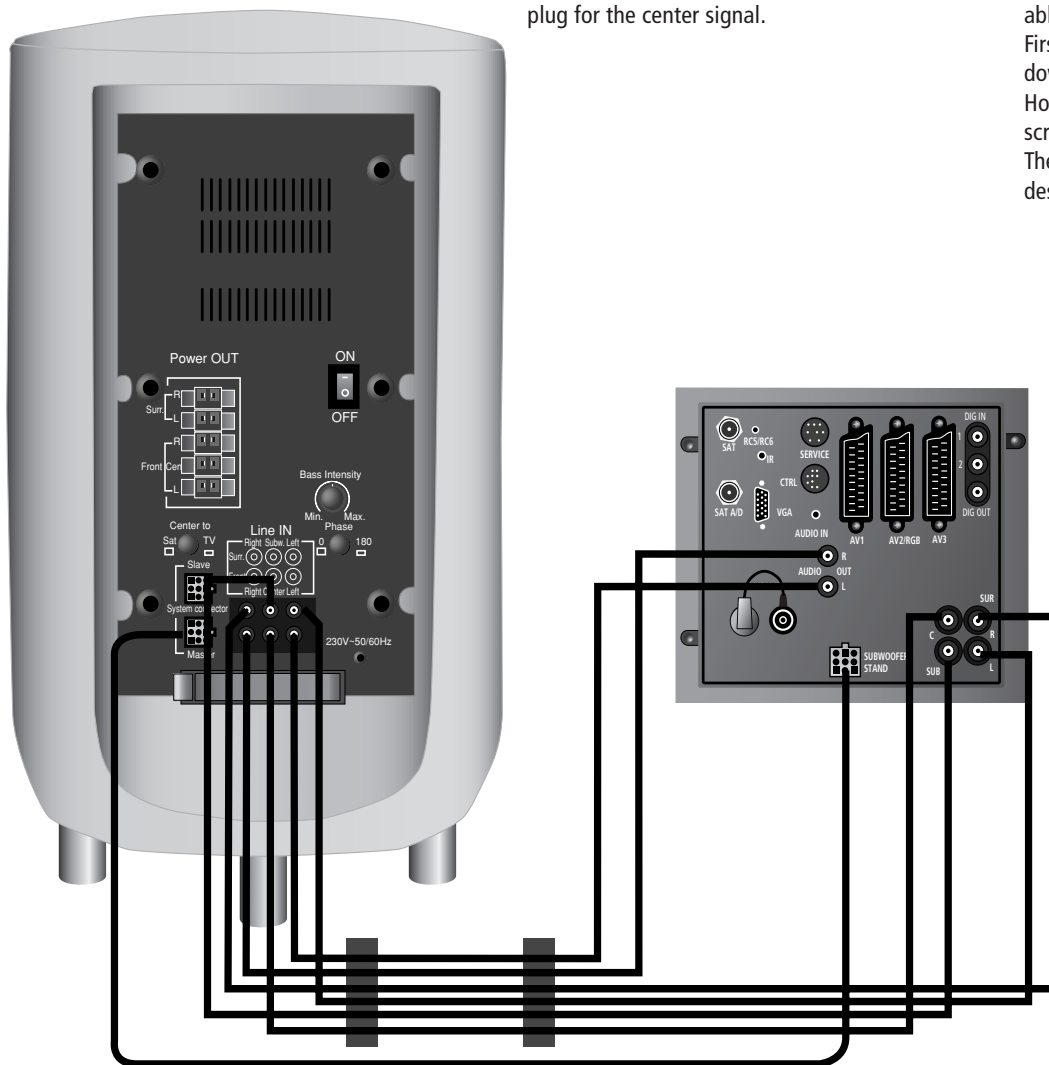

Connection

... to Articos 55 with Dolby Digital Module
(from software version 6.20)

See the instructions for laying the cables on
page 6.

The "Center" connections do not necessarily
have to be made because the center signal is
always played over the TV speakers.

Note: If the Tremo system is not selectable on
your set in the TV menu - Sound - under
"Sound via", have your dealer do a software
update.

How to connect the satellite speakers is
described on page 14.
The settings on the TV and on the subwoofer
are described on page 16.

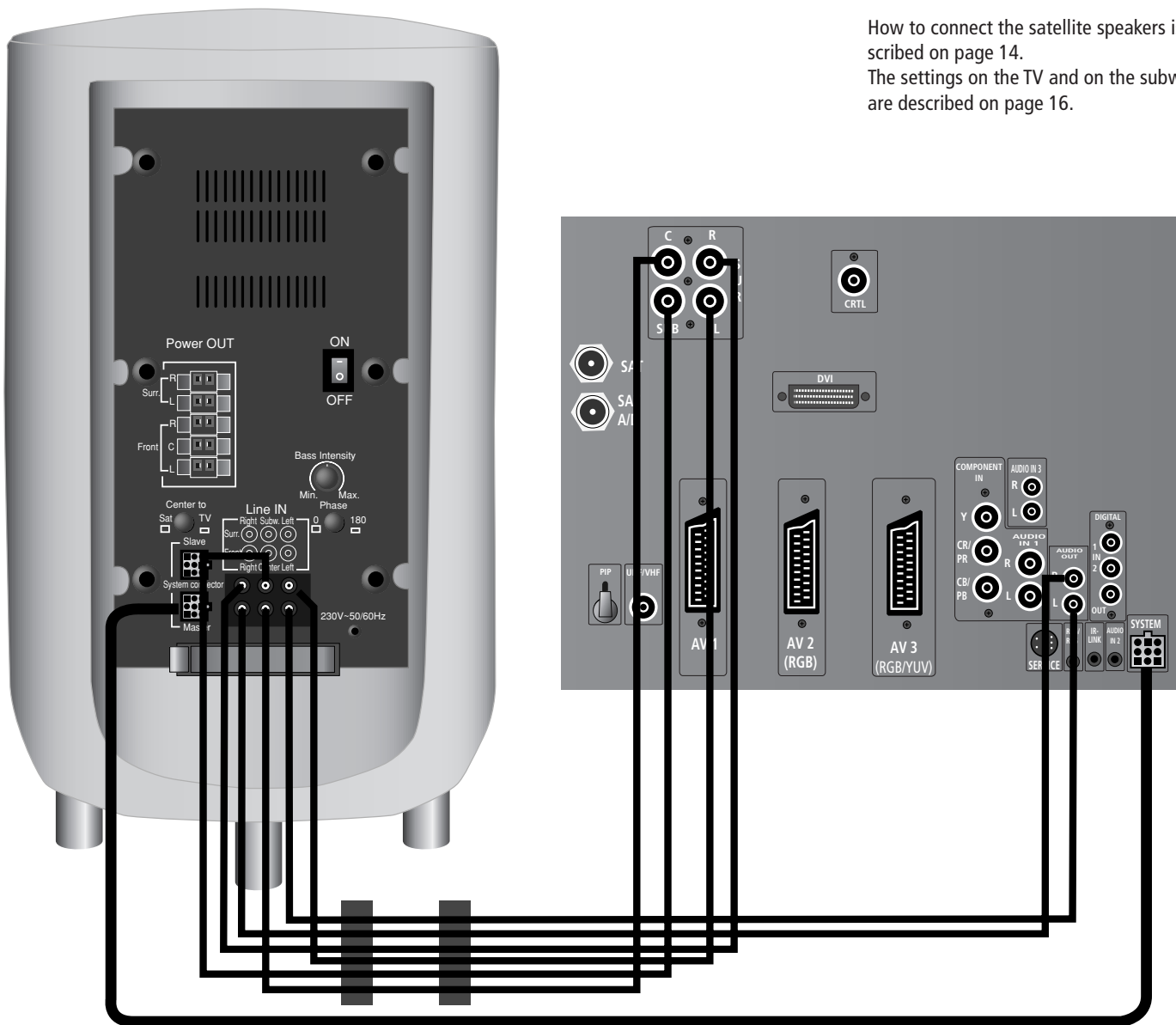

Connection

... to the Master Unit with Dolby Digital Module with Spheros 42 HD and Spheros 37 (from software version 6.14)

See the instructions for laying the cables on page 6.

The "Center" connections do not necessarily have to be made because the center signal is always played over the TV speakers.

Note: If the Tremo system is not selectable on your set in the TV menu - Sound - under "Sound via", have your dealer do a software update.

How to connect the satellite speakers is described on page 14.
The settings on the TV and on the subwoofer are described on page 16.

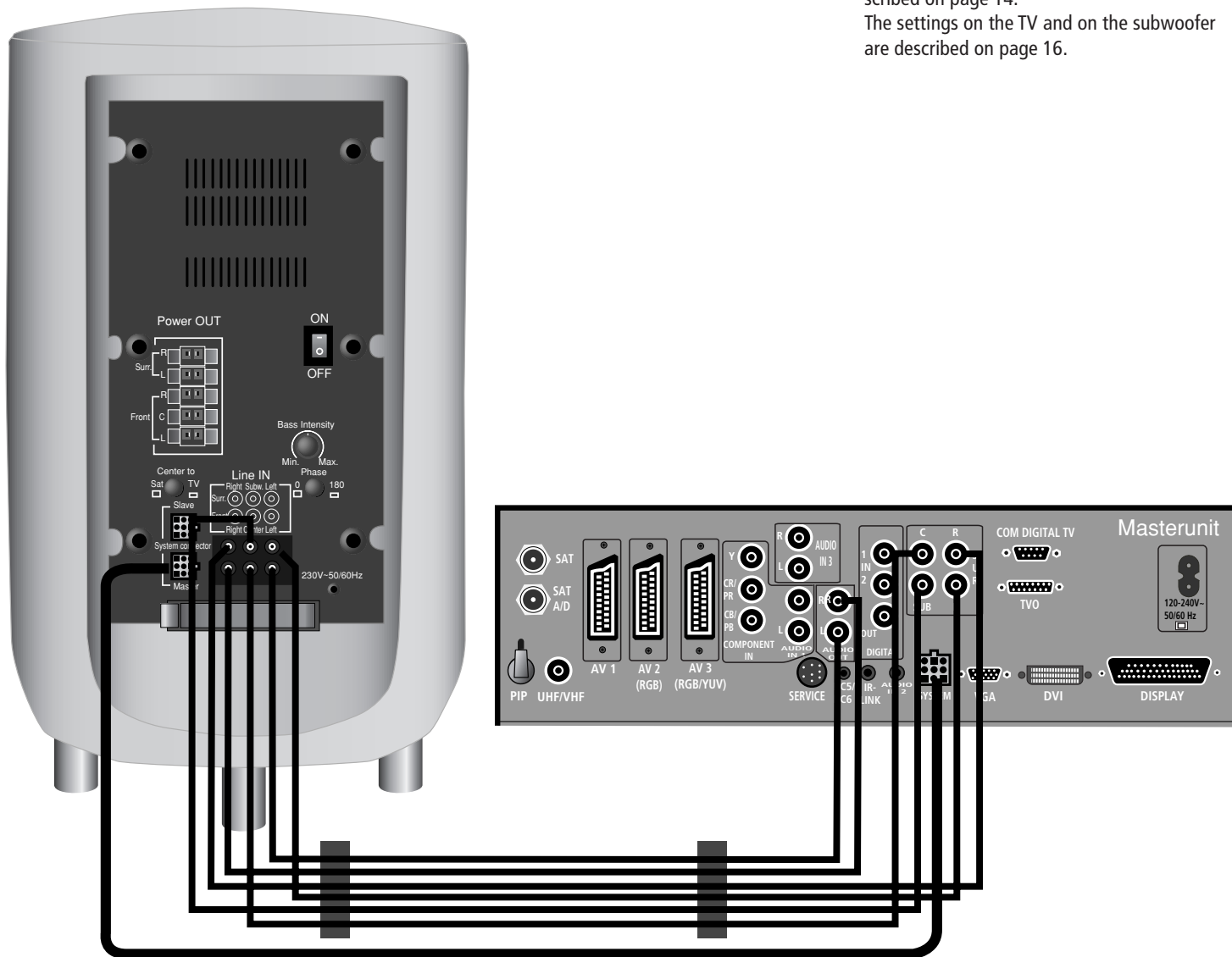

Connection

... to TV sets with the signal box with built-in Dolby Digital Module

See the instructions for laying the cables on page 6.

The "Center" connections do not necessarily have to be made because the center signal is always played over the TV speakers.

How to connect the satellite speakers is described on page 14.

The settings on the TV and on the subwoofer are described on page 16.

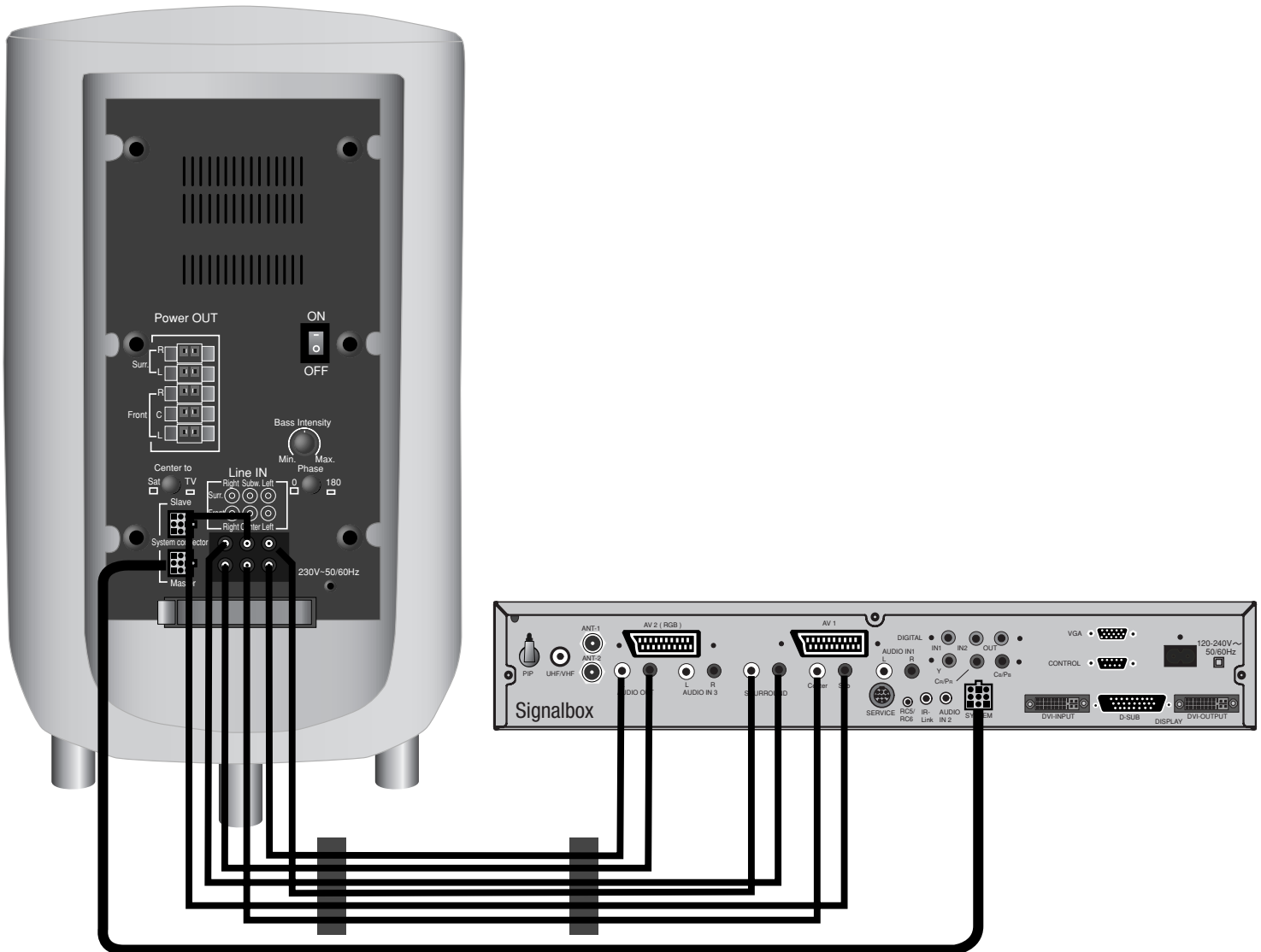

Connection

... to Loewe DVD Preceiver Auro 8116 DT with Loewe TV set (from Loewe TV MediaPlus Q2500, software 6.x)

If you use the Loewe DVD Preceiver in connection with a Loewe TV set, connect the Tremo speaker system to the audio outputs of the DVD Preceiver. See the instructions for laying the cables on page 6.

Connect the cubic socket on the DVD Preceiver to the "Master" cubic socket on the Tremo subwoofer. Use the cubic plug cable provided with the DVD Preceiver Auro (2-wire cable). Plug the white plug (without kink protection) into the cubic socket on the subwoofer.

If the Loewe TV speakers as of chassis MediaPlus Q2500 are used for center reproduction, connect the cubic socket on the TV with the "Slave" cubic socket on the subwoofer using the cubic plug cable. Use the cubic plug cable provided with the Tremo speaker system. Plug the white plug (without kink protection) into the cubic socket on the subwoofer. Set the "Center to" switch on the subwoofer to "TV".

If, on the other hand, you want to use the external center speaker, do not connect the Slave to the TV.

Set the "Center to" switch on the subwoofer to "Sat".

Connect the TV set (Euro AV socket 3) to the DVD Preceiver with the Euro AV cable.

Connect the TV (Service socket) to the L-Link socket of the DVD Preceiver with the TV-L-Link cable (provided with the DVD Preceiver).

This ensures that the Tremo speaker system is switched on but the TV stays switched off in the case of radio or CD playback from the DVD Preceiver.

If the TV set is equipped with a DVB module with Digital OUT terminal and/or the DIS module, connect the digital output of the TV to the DIGITAL IN input of the Auro system by a cinch cable (if a DVB module with Digital-OUT and a DIS module are available, use the DIS connection). This ensures that the digital audio signal is fed to the DVD Preceiver for decoding.

How to connect the satellite speakers is described on page 14.

Settings on the DVD Preceiver Auro 8116DT

In the DVD menu under Settings select "Tremo" as the speaker system, set the listener/speaker distances and level the loudspeakers. See also the DVD Preceiver manual (page 12 and 13).

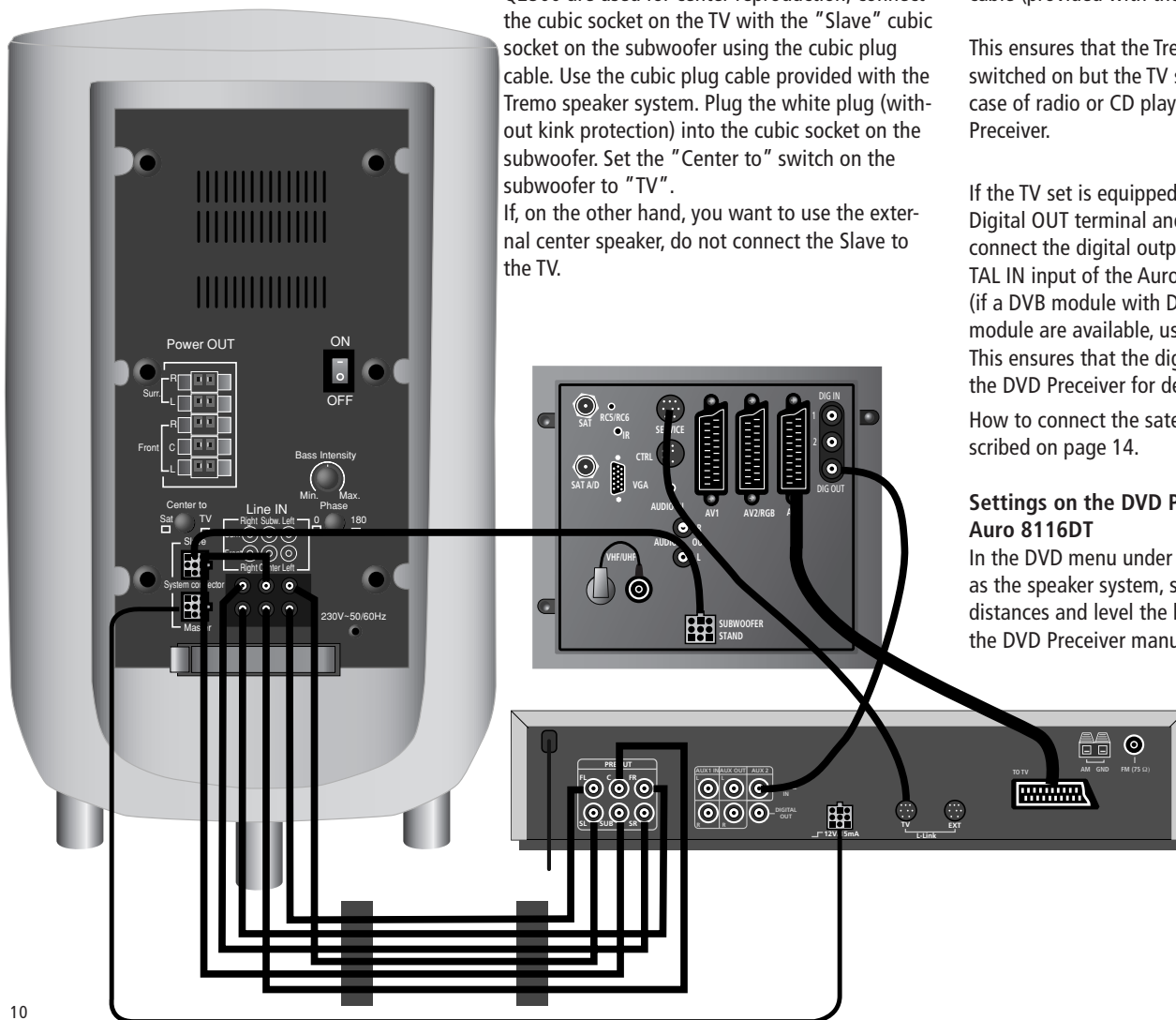

Connection

to the Loewe DVD Preceiver Auro 8116 DT with Articos 55 (from Software 6.15), Master Unit in Spheros 42 HD and Spheros 37 (from Software 6.20) or with the signal box

If you use the Loewe DVD Preceiver in connection with a Loewe TV set, connect the Tremo speaker system to the audio outputs of the DVD preceiver. See the instructions for laying cables on page 6.

Connect the cubic socket on the DVD Preceiver to the "Master" cubic socket on the Tremo subwoofer. Use the cubic plug cable provided with the DVD Preceiver Auro (2-wire cable). Plug the white plug (without kink protection) into the cubic socket on the subwoofer.

If the speakers of the Loewe TV set are used for center playback, connect the cubic socket on the TV set to the "Slave" cubic socket on the subwoofer with the cubic plug cable. Set the "Center to" switch on the subwoofer to "TV". If, on the other hand, you want to use the external Center loudspeakers, do not connect the Slave and the TV set.

Set the switch "Center to" on the subwoofer to "Sat".

Connect the TV set (Euro AV socket 2 for signal box or Euro AV socket 3 for Articos 55 and the Master Unit for Spheros) to the DVD Preceiver with the Euro AV cable.

Connect the TV set (Service socket) to the TV-L-Link socket of the DVD Preceiver with the L-Link cable (enclosed with the DVD Preceiver). This ensures that the Tremo speaker system is switched on for radio or CD playback but the TV stays switched off.

Connect the digital output of the TV set to the DIGITAL IN input of the Auro system by a cinch cable (if a DVB module with Digital-OUT terminal is installed, use the DIS connection). This ensures that the digital audio signal is fed to the DVD Preceiver for decoding.

How to connect the satellite speakers is described on page 14.

Settings on the DVD Preceiver Auro 8116DT

In the DVD menu under Settings select the "Tremo" speaker system, set the listener/speaker distances and level the speakers. Also see the DVD Preceiver manual (page 12 and 13).

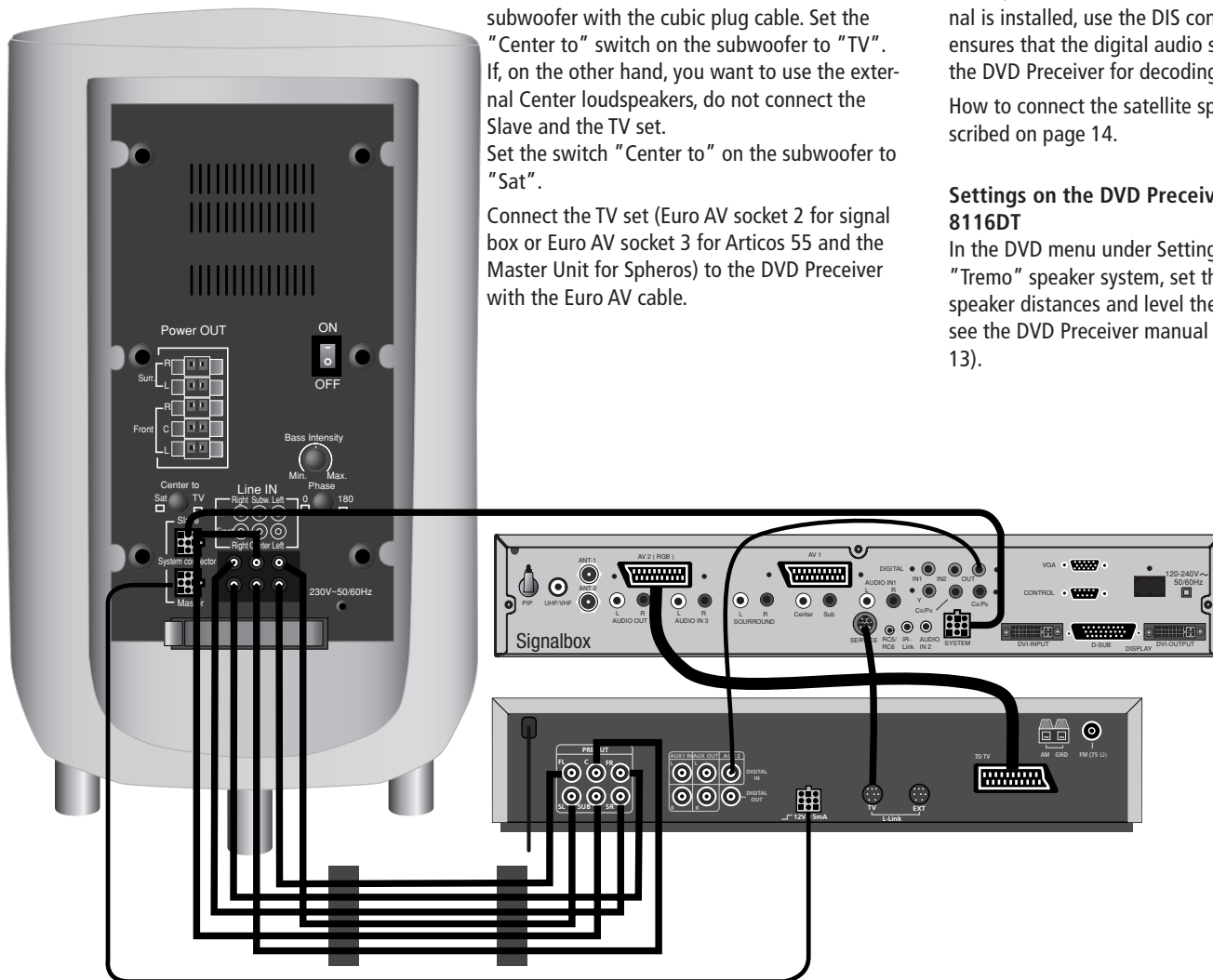

Connection

... to Loewe Certos with Loewe TV set (from Loewe TV MediaPlus Q2500, software 6.x)
Connecting cable to Certos system
Order no. 88947.001

If you use the Loewe Certos system with a Loewe TV set, connect the Tremo loudspeaker system to the audio outputs of the Certos system. See the instructions for laying the cables on page 6.

Connect the bass module left hand socket on the Certos system to the cubic "Master" socket on the Tremo subwoofer using the connecting cable order no. 88947.001.

If the Loewe TV speakers are used for center reproduction, connect the cubic socket on the TV with the "Slave" cubic socket on the subwoofer using the cubic plug cable. Set the "Center to" switch on the subwoofer to "TV".

If, on the other hand, you want to use the external center loudspeaker, do not connect the "Slave" to the TV.

Set the "Center to" switch on the subwoofer to "Sat".

Connect the TV set (Euro AV socket 3) to the Certos system with the Euro AV cable.

Connect the TV (SERVICE socket) to the TV-S-Link socket of the Certos system with the L-Link cable (provided with the Certos system).

This ensures that the Tremo speaker system is switched on but the TV stays switched off in the case of radio or CD playback from the Certos system.

If the TV set is equipped with a DVB-Module with Digital OUT terminal and/or the DIS-Module, connect the digital output of the TV set to DIGITAL IN of the Certos system by a cinch cable (if a DVB module with Digital-OUT terminal and a DIS module is available, use the DIS connection). This ensures that the digital audio signal is fed to the DVD Preceiver for decoding.

How to connect the satellite speakers is described on page 14.

Speaker settings for the Certos system:

Observe the settings for the Certos system speakers (see operating manual of the Certos system from page 25).

Set "small" for front, surround and center speakers.

Select "yes" for woofer.

Adjust the speakers (level) and also set the listener/speaker distances as described on page 27 of the Certos operating manual.

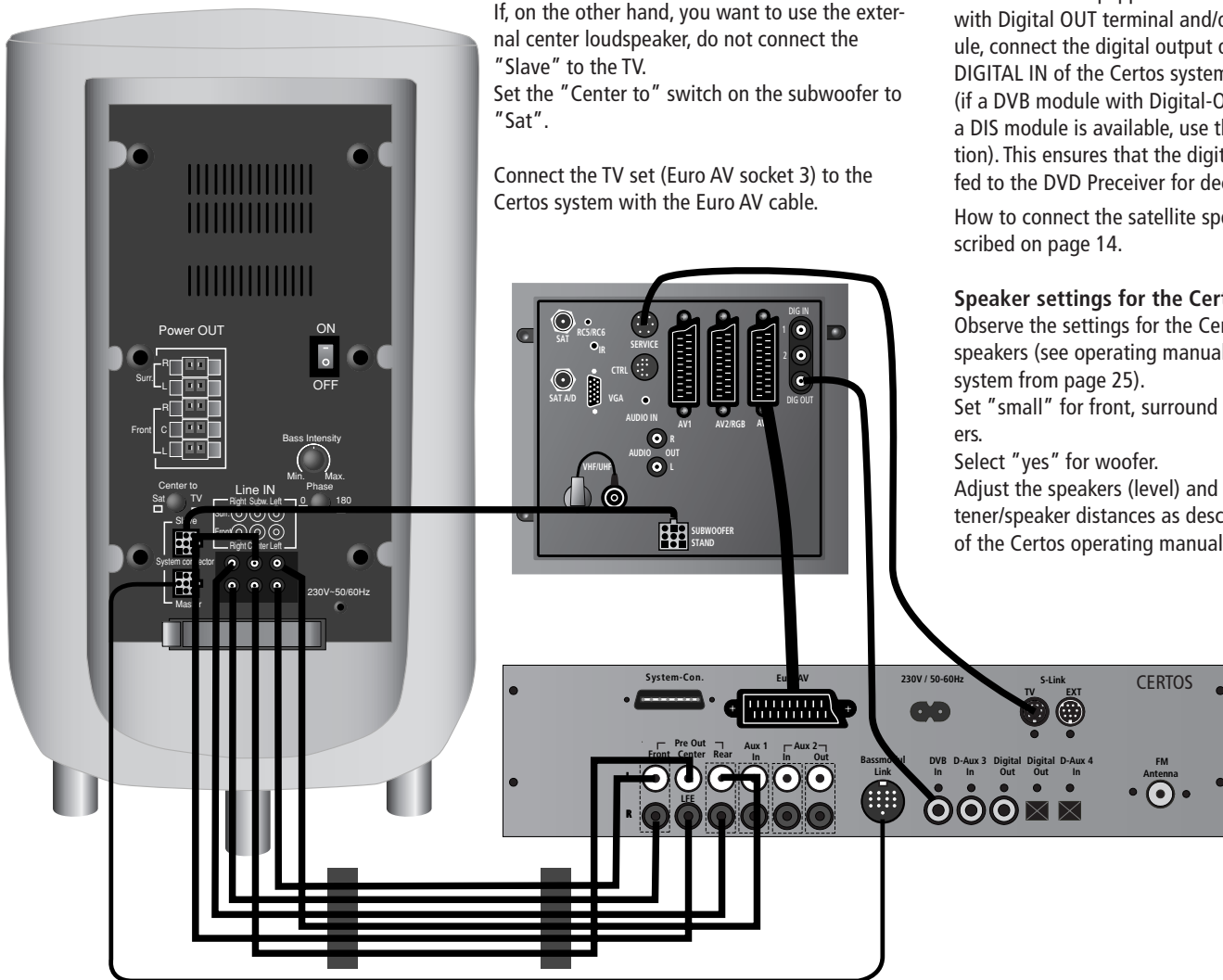

Connection

... to Loewe Certos with Articos 55 (from Software 6.15), with Master Unit for Spheros 42 HD and Spheros 37 (from Software 6.20) or with the signal box.
Connecting cable to the Certos system
Order No. 88947.001

If you use the Loewe Certos system with a Loewe TV with signal box or Articos 55, connect the Tremo speaker system to the audio outputs of the Certos system. See the instructions for buying the cables on page 6.

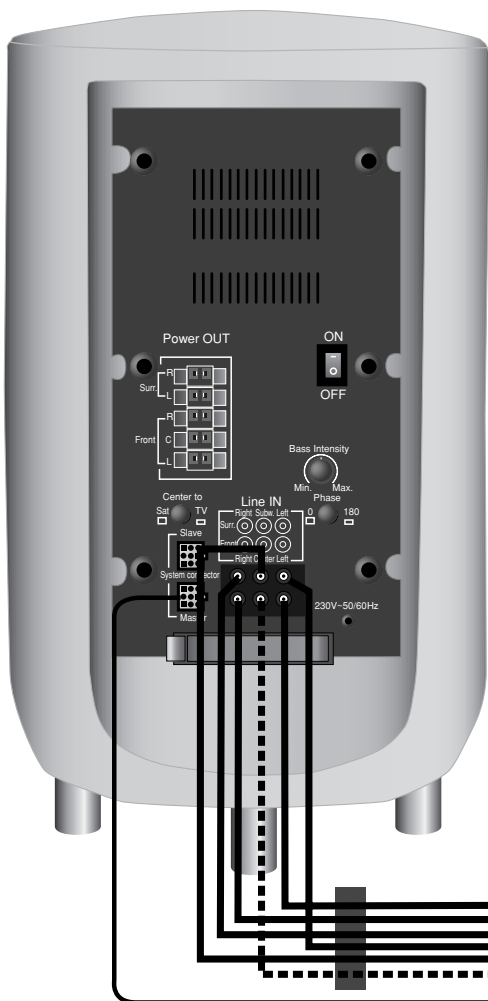

With the connecting cable order no. 88947.001 connect the bass module link socket to the Certos system with the cubic socket "Master" on the Tremo subwoofer.

If the TV speakers are used for center playback connect one of the two AUDIO IN 3 inputs on the signal box or Articos 55 to the Center connection on the Certos system with a cinch cable.

If, on the other hand, you want to use the external Center speakers, do not make the connection between the Certos system and AUDIO IN 3 described above. In this case, connect the Center connection of the Tremo bass module to the center output of the Certos system (this connection is shown by a dotted line in the drawing). Set the "Center to" switch to "Sat". Connect the TV set (Euro AV socket 2 for signal box or Euro AV socket 3 for Articos 55 and the Master Unit for Spheros) to the Certos system with the Euro AV cable.

Connect the signal box or the Articos 55 (SERVICE socket) to the TV-S-Link socket of the Certos system with the L-Link cable (enclosed with the Certos system). This ensures that the Tremo speaker system is switched on for radio or CD playback but the TV remains switched off.

If the Master Unit/signal box or Articos 55 is equipped with a DVB module, connect the digital output of the TV set to DIGITAL IN of the Certos system with a cinch cable (if a DVB module with Digital-OUT terminal is installed, use the DIS connection). This ensures that the digital audio signal is fed to the Certos system for decoding.

How to connect the satellite speakers is described on page 14.

Speaker settings for the Certos system:

Observe the settings for the speakers of the Certos system (see operating manual of the Certos system from page 25).

Set "small" for front and surround speakers. If the TV speakers are used as center speakers, set "TV", if you want to use the external speaker as center, set "small".

For woofer select "yes".

Also level speakers and set listener/speaker distances as described in the Certos operating manual on page 27.

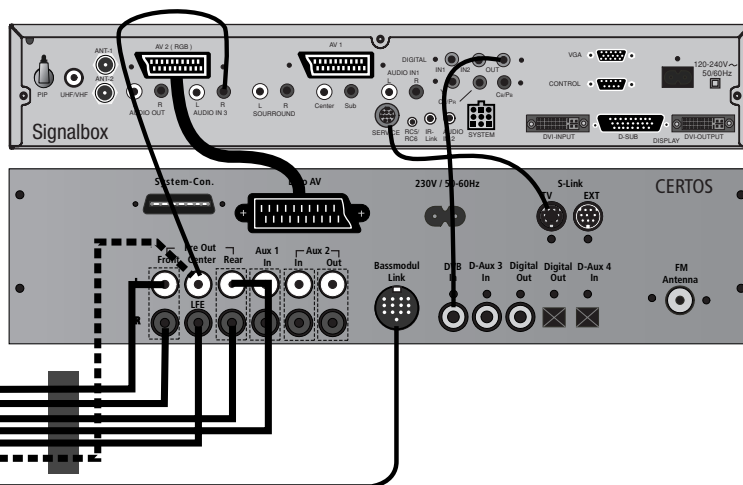

Connection

... Connecting the satellite speakers to the subwoofer

1. Remove the cover over the speaker connections from the satellite speakers.



2. One of the two wires of the speaker cables is marked black. Connect these black marked wires with the black terminal on the subwoofer and the black terminal on the satellite speaker. Connect the unmarked wires with the red terminals.
3. Push the cover over the speaker connections on the satellite speaker back on.
4. Lay all cables in the subwoofer downwards to be able to fix them with the cable clip.

... Connecting the subwoofer to the mains

Plug the mains plug of the subwoofer into a 230 V AC socket. Lay this cable downwards too.

Secure all the cables in the clip

Open the cable clip at the bottom of the subwoofer, lay all the cables in it and close the clip again. This fixes the cables.

Cover on the subwoofer

Replace the cover after making the following settings:

The center speaker can be omitted with Loewe TV sets from chassis MediaPlus Q2500, the center sound channel is reproduced by the TV speakers.

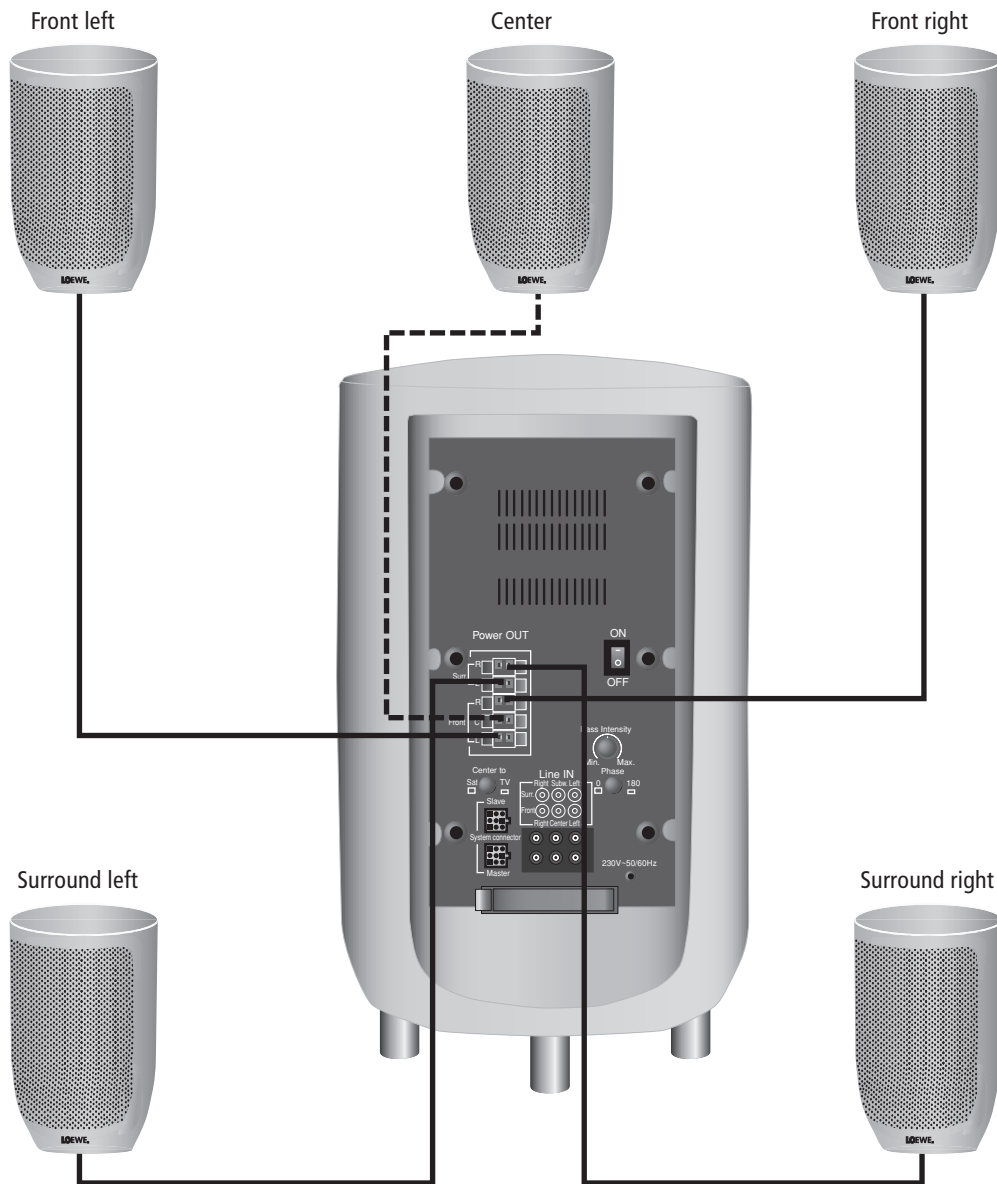

Mounting the satellite speaker on the S stand

You can mount the Tremo satellite speaker on the S stand. See the installation instructions provided with the stand.

You do not need the following parts:

Flange (2) and the screws (B, C1 – C3).

Proceed as follows:

- Fix the conical base (included in the scope of delivery of the Tremo speaker system) in place of the flange at the top end of the pillar with the screw (B). Use the screws provided with the Tremo satellite speaker.

Note:

The screws can be found with the speaker cable.

- Feed the speaker cable from top to bottom through the conical base. Leave about 5 cm of the speaker cable protruding.
- Remove the cover over the connections from the Tremo satellite speaker. Clamp the speaker cable in the clamp sockets. Push the cover back on.
- Pull back the speaker cable and place the Tremo satellite speaker on the conical base. It is connected with a bayonet catch with pins of different widths so that the speaker can only be mounted so that the terminals come to rest directly over the speaker cable. When the speaker has been inserted correctly in the bayonet, pull the speaker cable back again and fix it with a quarter turn to the left. If this proves difficult, wet the rubber foot of the satellite speaker slightly with a damp cloth.

- Now lay the cable in the groove of the pillar (3x).
- Proceed as described in the installation instructions for the S stand. The speaker cable of the Tremo satellite speakers has no plug connections, the stripped cable is simply clamped in sockets.

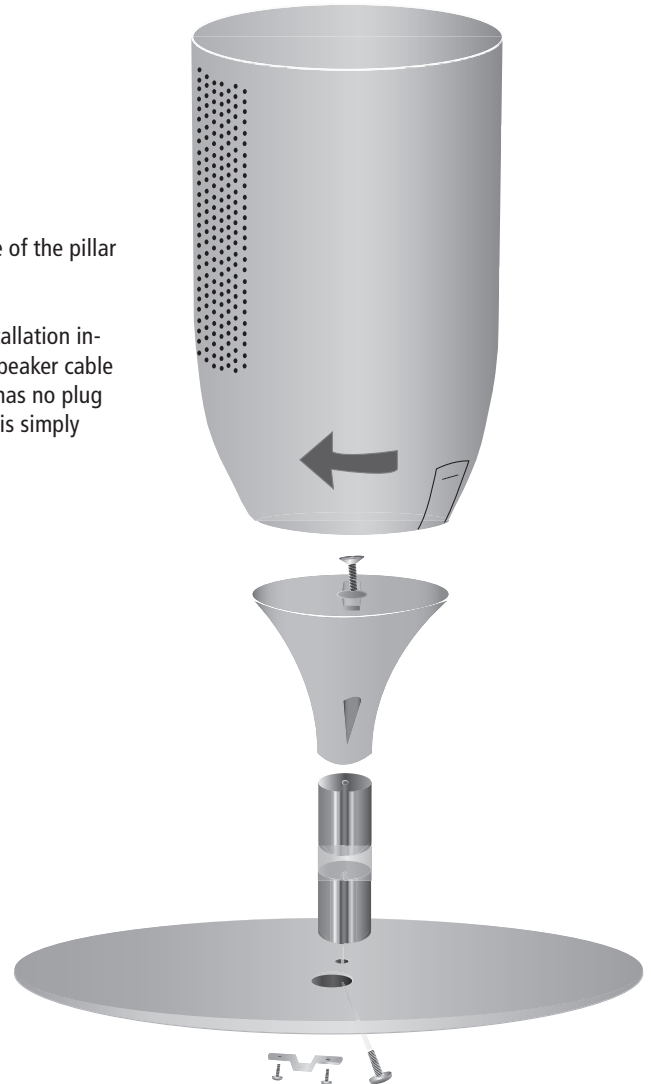

Start-up and operation

Select the center signal on the subwoofer

Use the "Center to" switch to set whether the center signal is to be reproduced via the Loewe TV speakers or by a separately installed center satellite speaker.

Switch pressed = center via TV set

Switch not pressed = center via satellite speaker

When connecting directly to TV sets with Master Unit or signal box and direct connection to Articos 55, this switching is not possible because the center signal is always played back over the TV speakers.

Switching the subwoofer on/off

You switch the Tremo speaker system on with the ON/OFF switch.

If the subwoofer is connected to a Loewe TV set, the Loewe DVD Preceiver or the Certos system, you no longer need to switch on and off on the subwoofer. After switching on the subwoofer for the first time it is always subsequently switched on and off automatically with the Loewe device.

Settings on the TV set

Sound via ...

If the Tremo speaker system is connected to the Dolby Digital Module of the TV set:

1. Call the TV menu with **M** or **MENU**.
2. Select "Sound" with the arrow buttons **▼ ▲**.
3. Call the Sound menu with **OK**.
4. Select the menu item "Sound via" in the Sound menu with the arrow buttons **▼ ▲**.
5. Select "Tremo" with the arrow buttons **◀ ▶** and confirm with **OK**.

Now the sound of the TV set is transmitted by the satellite speakers and the subwoofer.

Note: If Tremo is not selectable on your Loewe TV in the TV menu - Sound - under "Sound via", have your dealer do a software update.

Setting listener/speaker distances and adjusting speaker volumes

Setting of the listener/speaker distances and adjusting of the speakers to the same volume are carried out according to the operating instructions of the Dolby Digital Module, the Certos system or the DVD Preceiver. Set the "Bass Intensity" knob on the subwoofer to the center position before adjusting the speaker volumes.

Sound reproduction via Loewe TV (from MediaPlus chassis Q2500) with Tremo speaker system connected

If you temporarily do not want to use the Tremo speaker system and want to broadcast the sound exclusively through the Loewe TV speakers, select Sound – Sound via – "TV" in the TV menu as described above. Confirm with the **OK** key.

Note:

But please note the following for TV sets as of software 4.4: If you have switched over to sound reproduction via TV as described above, the subwoofer may not be disconnected from the mains or switched off with the ON/OFF switch or the cubic plug cable pulled out.

If you have done this, the sound is reproduced via the Tremo speaker system after switching the subwoofer back on or after plugging in the cubic plug or mains plug.

In such a case you have to switch the TV off and back on so that the Tremo speaker system knows that you only want to hear the sound over the TV set.

Phase switch/bass intensity

The phase switch and the bass intensity knob enable you to optimise bass reproduction.

We recommend you to proceed as follows:

- If the subwoofer is in the corner of the room, set the bass intensity knob to "Min".
- If the subwoofer is against a wall, set the bass intensity knob to the center position.
- If the subwoofer is standing freely in the room, set the bass intensity knob to "Max".
- Start playing a DVD for example.
- Have a second person activate the phase switch whilst you sit and listen.
- Decide for yourself which switch position reproduces the best bass sound.
- Also set the bass intensity to suit your taste.

Technical data

General

Subwoofer transmission range	40 Hz–150 Hz
Satellite transmission range	150 Hz–20 kHz
Mains voltage	220 – 240 Volt
Max. power consumption	250 Watt
Nominal power consumption	50 Watt
Power consumption on standby	< 0.5 Watt

Features

Digital output stages	6 channels
Subwoofer channel (rated/music output)	50/65 Watt
Satellite channels (rated/music output)	30/40 Watt
Bass intensity ± 12 dB	•
Phase switch	•
Power switch	•
System link	•

Upgrade kits/accessories

Speaker cables satellites FR, FL, Center	3x5m
Speaker cables satellites SR, SL	2x15m
Cubic plug cable	6m
Cinch/cinch cable	6m
Adapter for stands	5
Tremo wall holder (accessory)	Set 2 pieces
Dimensions WxHxD (with speaker) in cm	6.8x16x10.5
S stands	Set 2 pieces
Dimensions diameter of base plate x height (with speaker) in cm	25x103

Miscellaneous

Diameter/height subwoofer in cm	30.5x51.5
Diameter/height satellites in cm	10.5x16
Weight subwoofer in kg	15
Weight satellites in kg	1
Colour versions subwoofer/satellites	cream, platinum, anthracite

