

iRiver

U10 CRADLE KIT

GETTING STARTED

▷ User's Guide

Index

1 About U10 Cradle Kit

Introduction to U10 Cradle Kit	02
Getting Started	03
Locating the Controls	04

2 Using U10 Cradle Kit

Connecting to a Computer	05
Placing U10 In the Cradle	05
Detaching U10 from the Cradle	06
Turning on U10	07
Charging the Battery	08
Connecting to External Audio Player	09
Tips	10

3 Additional Information

Precautions & Safety	11
Warranty	12

About U10 Cradle Kit

Introduction to U10 Cradle Kit

U10 Cradle Kit is a mounting cradle specially designed for iriver U10.
With U10 Cradle Kit, you can:

- Store various kinds of media including music and other data
- Charge your U10 via the connection to a computer or to AC adapter (AC adapter is not included)
- Enjoy music, video, and flash games with built-in stereo speakers
- Make U10 a photo album on the desk
- Record from an external audio player
- Connect to external speakers
- Use Alarm Clock easily with the Snooze button
- Use the remote control to operate U10

Getting Started

Your U10 Cradle Kit package includes the following components:



Cradle

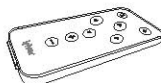

Remote Control



User's Guide



Line-In/Out Cable



Audio Extension Cable

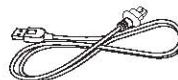

USB Cable

NOTE

U10 is not included in the package.

Locating the Controls

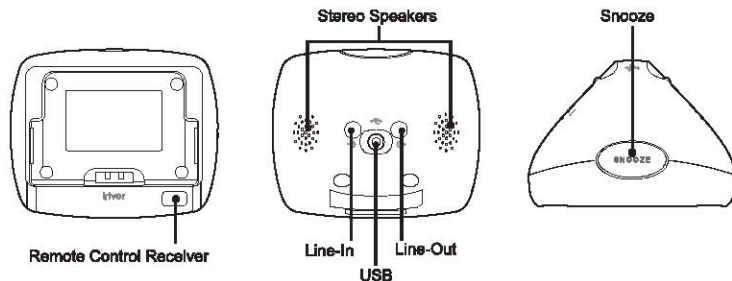

Volume Control Up/Down/Left/Right

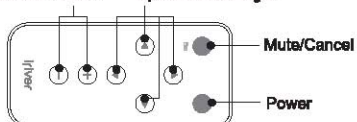

Put the battery into the remote control as follows.

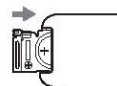

NOTE

- Press the Mute/Cancel button to exit from Flash contents.
(The Mute/Cancel button is same as the Pivot button on the U10.)
- The remote control uses CR2025 3V battery.

Using U10 Cradle Kit

Connecting to a Computer

- 1 Connect the included USB cable to the back of the cradle.
- 2 Connect the other end of the USB cable to the computer

Placing U10 in the Cradle

- 1 Press the inside of cradle.
- 2 Place U10 in the cradle.
Press the top of U10 to make sure U10 is secured.
- 3 Press the top of U10's LCD until the "click" sound is heard.

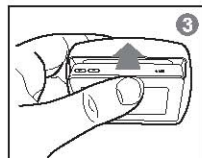
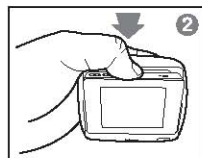
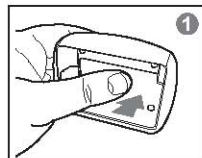

Detaching U10 from the Cradle

Press the top of U10's LCD again to detach from the cradle.

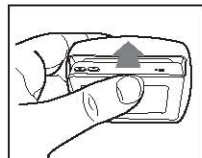

Turning on U10

Turn U10 on with the remote control if you placed U10 in the cradle.



You can select one of the following options when connecting U10 to the computer :

- **Power Only** : U10 will operate using the power supply from the computer. You can use U10 to play music and other media files.
- **Power & Data** : Media files and data can be transferred to U10.

NOTE

- Make sure U10 is correctly placed in the cradle. Otherwise, U10 may malfunction or may not be connected to the computer.
- Use the remote control to operate U10 placed in the cradle.
(When U10 is connected to a computer in Power & Data mode, you cannot use the remote control.)

Charging the Battery

- While U10 is connected to a computer via USB cable, it will charge its built-in battery. The battery is 50-percent charged in about 1 hour, and fully charged in about 2.5 hours.
- Only use the USB cable included in the package. Otherwise, the device may malfunction.
- Check if U10 is connected to a high-power USB 2.0 port. Some low-power USB ports available in keyboards and other USB hubs may not provide enough power to charge or sync U10.
- If the computer is in sleep mode, U10 may not be charged.

NOTE

- To charge U10 with AC adapter, USB-DC adapter is required. Please visit www.iriver.com to purchase AC and USB-DC adapter.
- The AC adapter for U10 uses input voltage of 100~240V and 50/60Hz, and output voltage of 5V and 2A.

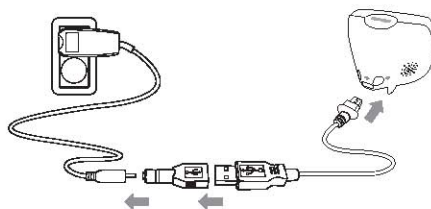

Connecting to External Audio Player

Line-In

- 1 Connect the included Line-In/Out cable to the Line-In jack located on the back of the cradle.
- 2 Connect the other end of the Line-In/Out cable to the Line-Out or Earphone jack of the external audio player.

Line-Out

- 1 Connect the included Line-In/Out cable to the Line-Out jack located on the back of the cradle.
- 2 Connect the other end of the Line-In/Out cable to the Line-In jack of an external audio player or external speakers.

NOTE

- Use the audio extension cable if the audio jack of the optional stereo cable is too big to plug into Line-In or Line-Out jack of the cradle.

Tips

Using Snooze Button

Use Alarm Clock easily with the Snooze button. When the alarm sounds, press the Snooze button to suspend the alarm for 10 minutes. You can press the Snooze button up to 4 times. Press and hold the Snooze button to disable the alarm.

Using FM Radio

The earphone cord serves as the antenna for U10. Therefore, while U10 is in the cradle, you cannot use the features related to FM Radio such as FM recording and FM alarm.

Additional Information

Precautions and Safety

Electricity (AC adapter is not included in the box)

- 1 Do not overload a single power circuit.
- 2 Firmly plug the adapter into the wall socket. Unplug the adapter when it's not in use.
- 3 Do not kink or crease the power cable or place heavy objects on the power cable.
- 4 Immediately power off the player and unplug the AC adapter if water or other liquids are present.
- 5 Immediately power off the player and unplug the AC adapter if smoke or odor emits from the player or adapter.
- 6 Unplug the AC adapter during electrical storms.

Product

- 1 Do not place heavy objects on the player.
- 2 Keep away from harsh environments including humid, dusty, and smoky areas.
- 3 Avoid contact with water and other liquids.
- 4 Do not use excessive force on the buttons.
- 5 Keep out of direct sunlight and extreme heat and cold.
- 6 Do not drop or subject the device to impact.
- 7 Do not clean with chemical or detergent.
- 8 Keep the player away from strong magnets.
- 9 Do not assemble or modify.
- 10 Do not disconnect USB cable while transferring data.



U10

Additional Information

Warranty

Please refer to the following iriver website for iriver warranty policy.
<http://www.iriver.com / warranty>

MEMO

MEMO
