

290mm

205mm



Aurora S12  
2.0 CH MULTIMEDIA SPEAKER SYSTEM

OPERATIONAL  
MANUAL



**DEAR CUSTOMER**  
Thank you for purchasing our product  
Please read this manual carefully before using the product.

TECHNICAL SPECIFICATIONS

- Total wattage RMS: 2x6 W
- Frequency response: 100Hz-20kHz
- Subwoofer: 76 mm
- Controls: volume control, power on/off,
- Headphone jack: 3.5 mm mini-jack
- Satellites dimensions: 105x105x177 mm

PACKAGE CONTENTS

2 satellites

Warranty service coupon  
Operational manual

The manufacturer reserves the right to make any technical changes to the product.

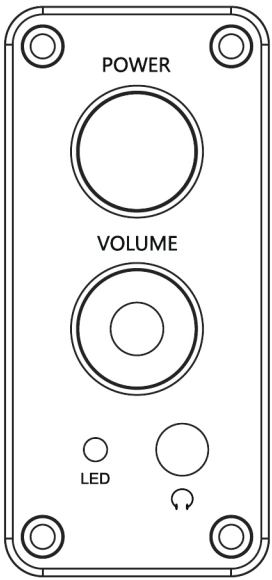

VOLUME - master volume  
POWER- system power on/off  
- headphone jack

**NOTE:**  
Do not place the system next to device issuing magnetic fields.

205mm

290mm

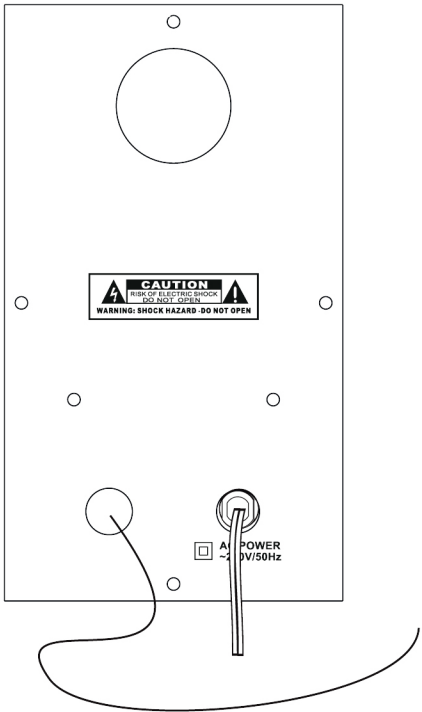

**ATTENTION:**  
Before switching on power supply of the system make sure that all satellites and all external devices are connected.  
**ATTENTION:**  
Make sure that all cables are plugged tightly in the respective sockets. Otherwise, noise or other sound artefacts may occur.

Speaker System Layout

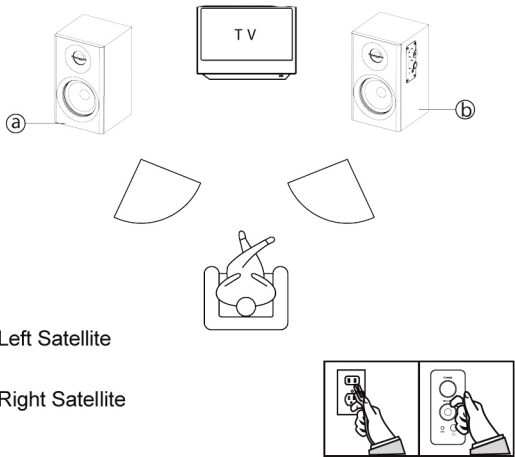

**Attention!**  
Upon receiving the product (goods, subwoofer, satellites), check it for integrity and absence of loosely moving items inside. Do not expose the device to mechanic loads that can lead to mechanic damages of the device. The warranty becomes invalid, if the device suffers any mechanic damage.  
Keep the device away from moisture, liquids (water, acid, solutions, oils, solvents, etc), protect it from vibration, high temperatures (over +50°C) and mechanic loads. No objects filled with liquids, such as vases, shall be placed on the satellites and subwoofer; also never place the subwoofer and satellites on wet or moisturous surfaces.  
Store and use the device in a dry room at 20-90% humidity level, avoid moisture condensation. Should moisture condensation occur, allow time for the device to dry. Moisture may damage both the shell of the device (goods, subwoofer, satellites) and its inner elements, and such damage is not covered by the warranty. The device can only be used and stored at temperatures between +5 °C and +40 °C where moisture condensation does not occur. If the device was shipped at negative temperatures, allow 3 hours for the device to warm indoors at +16-25°C before using it.

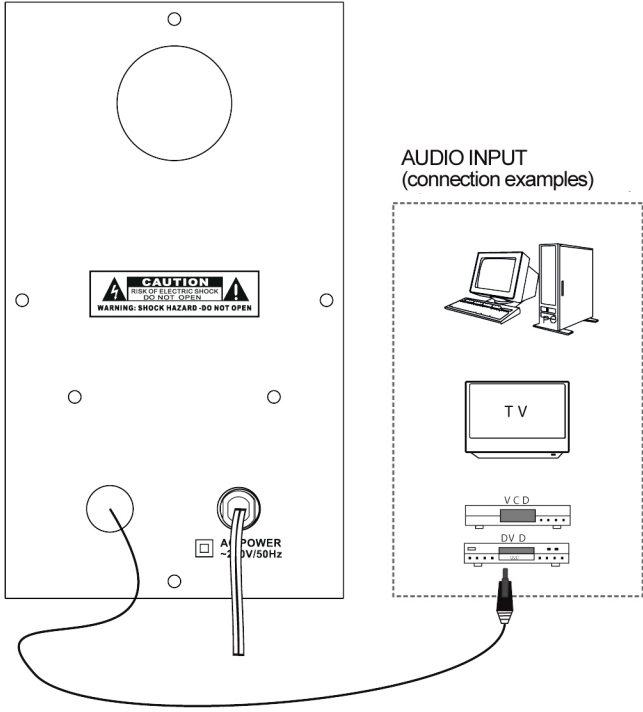

**Equipment Connection**  
Connectors of the audio cables are marked by the colour defining the sound channel: red colour means left channel (L), white - right channel (R). The audio devices are connected by connecting 3.5 mm mini-jack cable to AUDIO INPUT port on the side panel of the subwoofer.

It is not allowed to run the device at maximal volume level for more than 2 hours on end, as it may lead to device damage (goods, subwoofer, satellites, other components damage). Reason of damage will be a burnt fusetron of power transformer and/or burnt amplifier and/or driver of the subwoofer or satellite. After the device has been used at maximal volume level, it should be disconnected from power supply and not used in the following 8 hours. It is forbidden to use the device, if any noticeable sound distortions occur (such as clicks or wheezes, etc). In this case volume level should be reduced and/ or frequency timbre should be changed (if the system configuration and/or signal source configuration allow this) until the distortion disappears completely.  
Please, adjust volume level accordingly in order not to damage your hearing and the system, avoid wheezing sound (sound with a high level of harmonic distortion). Using the stereo system with high level of harmonic distortion (wheezing/distorted sound) may lead to damage of the device (goods, subwoofer, satellites), which is not covered by the warranty. Reason of damage will be a burnt fusetron of power transformer and/or burnt amplifier and/or driver of the subwoofer or satellite. Please, reduce the volume level in a way to achieve undistorted sound. It will help to keep your hearing and your device (goods, subwoofer, satellites) in good condition. Please, do not connect audio cable from output of another functioning signal amplifier (over 1W, 0.5 W) to audio in of this system. You can find information about parameters of the signal amplifier in the documentation of the signal source or in the documentation of its manufacturer.  
The device is designed to be used with 198-242V (220V+/-10%) / 50/60 Hz public power supply systems. Damages to the device (damaged inbuilt safety fuse or burnt transformer) as a result of exploitation with power systems with characteristics different from those indicated above are not covered by the warranty. Please, switch off the system when unused for long periods of time. Do not open the device. Refer all servicing to qualified service personnel. Opening the device generates risk of electric shock. Please refer all issues of maintenance and replacement of a non-functional device to the seller or to DEFENDER authorized service center. The warranty becomes invalid, if the above operation rules were not respected, or if the device suffers any mechanic damage.

